

2008 Clean & Safe Neighborhood Parks Bond

QUARTERLY STATUS REPORT PRESENTED TO THE

Citizens' General Obligation Bond Oversight Committee

July 2014



Glen Canyon Park Opening Day March 15, 2014

PREPARED BY

Taylor Emerson, Recreation & Parks Department, Analyst, 581-2546, taylor.emerson@sfgov.org
Nate Cruz, Port of San Francisco, Analyst, 274-0518, nate.cruz@sfport.com

PRESENTED BY

Dawn Kamalanathan, Recreation & Parks Department, Director of Planning and Capital Management, 581-2544

dawn.kamalanathan@sfgov.org

Elaine Forbes, Port of San Francisco, Deputy Director of Finance & Administration, 274-0445

elaine.forbes@sfport.com



2008 Clean & Safe Neighborhood Parks Bond

Citizens' General Obligation Bond Oversight Committee

July 2014

TABLE OF CONTENTS

Executive Summary

- Program Summary 3
- Program Background 5
- Program Budgets and Funding..... 6

Project Status Summaries 7

Program Timeline & Schedule..... 26

Program Budget

- Program Revenues 28
- Program Expenditures..... 29

Program Summary

OVERVIEW

In February 2008, San Francisco's voters approved the 2008 Clean and Safe Neighborhood Parks General Obligation ("2008 Bond"). The 2008 Bond provided \$150 million in funding to the Recreation and Parks Department and \$35 million to the Port of San Francisco for specific, voter-approved parks and open space recreation projects. Below is a summary of the status of the agencies' progress, followed by additional detail on each project.

Recreation and Parks Department Projects

As of June 30, 2014, there are eleven (11) Neighborhood Park projects complete and Open to the Public: McCoppin Square, Helen Diller Playground at Mission Dolores, Mission Playground, Chinese Recreation Center, Fulton Playground, Sunset Playground, Lafayette Park, Cabrillo Playground, Cayuga Playground, Palega Playground, and Glen Canyon Park; two (2) projects in construction: Mission Dolores Park and Raymond Kimbell Playground. The Citywide programs are proceeding under their implementation plans.



Neighborhood Park highlight:

Following more than two and a half years of planning, design, and construction, Glen Canyon Park opened to the public on March 15, 2014. New park features include site reconfiguration and significantly improved access, renovated tennis courts, all new and expanded playground, extensive forestry work along with new tree plantings, a new accessible restroom, and overall site reconditioning. Several Trail improvements projects throughout Glen Canyon, funded in part by the 2008 Bond, are in Construction now, and Planning is underway with 2012 Bond funds to renovate the Recreation Center.



Citywide Program highlight: The Community Opportunity Fund program is progressing! Of the 26 projects selected for funding in the 2008 bond, 11 are now complete and Open to the Public, including Waterfront Playground, pictured here. Seven (7) are in construction, and the remaining eight (8) are working to meet community funding requirements and/or in design. Approximately 70% of the COF program funds are spent or encumbered.

Program Summary

Waterfront Parks highlights:

The Port received authority to issue \$33.5 million dollars to be expended on projects to improve waterfront open spaces. Highlights of these Port projects are described below.

- As of May 31, 2014, 5 of the 10 Port projects are substantially complete, including Pier 43 Bay Trail Link, Bayfront Park, Heron's Head Park, and Brannan Street Wharf projects, and the Blue Greenway Planning & Design Guidelines.

Future Bond Sale Plans:

- In April of 2014, a supplemental appropriation redirecting \$1.1m from 3 complete or near-completed projects to 2 underfunded projects was completed. Note the budget figures in these tables were manually updated to reflect the results of the supplemental.
- The third bond sale was successfully completed in February 2012 and proceeds were appropriated. This was the third and final sale for Recreation and Parks and will fund all remaining design and construction. The fourth and final bond sale for the Port of San Francisco's waterfront park projects is anticipated for early 2015.

Program Background

- The Port of San Francisco's Waterfront Parks program includes community planning efforts for the Blue Greenway and constituent parks, as well as new open space projects in the Northern Central Waterfronts. The program will add or improve seven open spaces and total \$33.5 million.

Program Summary

Program Background

- In February of 2008 the citizens of San Francisco passed Proposition A, a \$185 Million General Obligation Bond, known as the 2008 Clean and Safe Neighborhood Parks Bond.
- The \$185 million in bond funding is divided into two allocations based on the jurisdiction of the parks and facilities scheduled to receive funding, with \$151.3 million committed to the Recreation and Parks Department and \$33.5M dedicated to the San Francisco Port. \$185,000 is set aside in a Citizen's Oversight Audit fund.
- The objectives of this bond program are as follows: 1) Fix and improve park restrooms citywide; 2) Eliminate serious earthquake safety risks in neighborhood and waterfront park facilities; 3) Renovate parks and playgrounds in poor physical condition; 4) Replace dilapidated playfields; 5) Repair nature trail systems in the city's parks; and 6) Attract matching community and philanthropic support.
- The Recreation and Parks Department's 2008 Clean and Safe Neighborhood Parks Bond Program is divided into six sub-programs. The bulk of funding (80%) is dedicated to funding Major Capital Renovations at 12 Neighborhood Parks. The remaining funds (20%) are divided between five City- Wide programs.
 - Major capital renovation of Neighborhood Parks. The bond program allocates the majority of its funds to capital improvements at Neighborhood Parks across the city. These parks were selected based on the extent to which they are unsafe in an earthquake, in poor physical condition, as well as their ability to provide basic, recreational uses to many San Franciscans.
 - Restroom Repair and Replacement Program. Many of the city's park restrooms are in a state of severe dilapidation; some bathrooms require replacement, others require repairs, and some parks need restrooms. The \$11.4 million will fund a restroom replacement, repair, and installation program. Sites will be chosen in coordination with the community, through an open process guided by the Recreation and Parks Department Commission.
 - Park Playfield Repairs and Reconstruction. The City's playfields have been "loved to death"- overused due to a citywide shortage of soccer, baseball and multi-use fields. With the growing demand of field athletics, it is difficult to meet demand while keeping the fields at an acceptable playing condition. Over the past five years, a successful public/private partnership between the Recreation and Parks Department and the City Fields Foundation has resulted in the renovation of playfields at 6 park facilities with a current philanthropic contribution of over \$14 M. Each field has become some of the most requested play fields by park users. These renovated fields are improved by the installation of synthetic turf and night lighting which increased play time by more than 31,000 hours, while reducing maintenance needs and water demand. This \$8.5 million will continue that partnership.
 - Park Forestry Needs. Over 100,000 trees populate the city's parks and open spaces. These funds will provide for an assessment of the health and condition of this urban forest, as well as provide resources to enact the recommendations of the assessment and plant new trees.
 - Park Trail Reconstruction. The 2004 Recreation Assessment identified walking and biking trails as the #1 most needed recreational amenity; residents also cited hiking and visiting nature as the two activities in which they would like to participate in more often. The Park Trail Reconstruction program will restore trails and make capital improvements that allow residents to enjoy and experience nature in the parks.
 - Community Opportunity Fund (formerly Community Opportunity Grants Program). The Community Opportunity Fund Program is a capital program that allows residents, neighborhood groups and park advocates to initiate improvements in their parks by matching community-nominated capital projects with other private gifts and grants.

Program Background

- The Port of San Francisco's Waterfront Parks program includes community planning efforts for the Blue Greenway and constituent parks, as well as new open space projects in the Northern Central Waterfronts. The program will add or improve seven open spaces and total \$33.5 million.

Program Summary

Program Budgets and Funding

- Budgets

Recreation and Parks Department:

Major Capital Program	
Chinese Recreation Center	14.2
Mission Playground	7.5
Palega Recreation Center	21.2
Cayuga Playground	7.3
McCoppin Square	5.3
Sunset Playground	13.7
Fulton Playground	4.2
Mission Dolores Park	13.2
Cabrillo Playground	4.5
Glen Canyon Park	5.8
Lafayette Park	10.2
Raymond Kimbell Playground	3.3
NP Contingency Funds	4.7

Major NP Projects Program \$115.1M

Citywide Programs	
Restroom Repair Program	11.4
Park Playfields Program	8.5
Park Forestry Program	4.0
Park Trail Program	5.0
Community Opportunity Fund	5.0

Other Citywide Programs \$33.9M

Bond Issuance Costs¹ \$2.3

RPD Bond Program Total \$151.3M

Port of San Francisco:

Major Capital Program	
Pier 43 Bay Trail Link	7.7
Brannan Street Wharf	2.9
Blue-Greenway Improvement	21.4
Blue-Greenway DS Standard	.2
CEQA Review & Permitting	.6
WP Bond Issuance Cost	.7

Major WP Projects Program \$33.5M

CGOBOC Audit Costs .2

TOTAL Bond Program \$185.0M

Funding

Based on the adopted project budgets and schedules, a plan has been developed to break funding into three sales. The strategy for sales is as follows:

- Sale 1 was completed in August 2008 to fund planning and design for the first 7 of 12 Major Capital projects (Phase I)², Citywide Programs, and Waterfront Parks.
- Sale 2 was completed in early April 2010. Funds from this sale are intended for the construction of Phase I projects, Waterfront Parks, and Citywide Programs; and planning and design of the remaining five Major Capital projects (Phase II)², Citywide Programs, and Waterfront Parks.
- Sale 3 funded construction of Waterfront Parks, and all remaining RecPark projects.
- Sale 4 will fund all Waterfront Park projects.
- The sale forecast developed for the projects managed by the Recreation and Parks Department and the San Francisco Port is as follows:

Sale	Date	Amount
1st Sale	8/2008	\$ 42,520,000
2nd Sale	4/2010	\$ 60,430,000
3rd Sale	2/2012	\$ 73,355,000
4 th Sale	TBD	\$ 8,715,000
TOTAL		\$185,000,000

Distribution of the sale revenue between the agencies, and those budgeted for other bond related costs is outlined below. Other costs include the cost of bond issuance, bond oversight and program auditing.

Sale	SFRPD	SF Port	Other
1st Sale	\$38,457,502	\$3,644,438	\$418,060
2nd Sale	\$49,415,317	\$10,616,312	\$398,371
3rd Sale*	\$62,300,484	\$10,415,765	\$638,751
4 th Sale*	\$0	\$ 8,465,000	\$250,000

* Other costs to be determined, therefore distribution is only conceptual.

Project Status Summaries

- Major Neighborhood Park Phase I Projects:**

Chinese Recreation Center

Project Location: 1101 Washington Street

Project Manager: Toks Ajike
toks.ajike@sfgov.org; (415) 581-2543

Project Description: Work at the Chinese Recreation Center included full replacement of the recreation center; repairs and renovation of the court and children's play area; restoration of existing pathways; upgrades to site infrastructure; improvements to accessibility and overall reconditioning of the park landscape. Construction is complete and this project was **Open to the Public in July 2012**.

Project Schedule:

	Start	Finish
Baseline/Original	Pre-2008	Sep 2010
Actual	Jun 2008	July 2012

Project Budget

Original Budget	\$20,704,394
Current Budget	\$20,704,394
Current Projected	\$20,487,430
Actual Expenditures	\$19,366,336



Mission Playground

Project Location: 19th and Linda Street

Project Manager: Toks Ajike
toks.ajike@sfgov.org; (415) 581-2543

Project Description: The Mission Playground scope included renovated athletic courts; seismic upgrades to the clubhouse; renovated pathways; improvements to the swimming pool filter, site irrigation, and lighting; removal of ADA accessibility barriers; addition of shading devices and overall reconditioning of the park landscape. Additionally, through the generosity of the City Fields Foundation, the Mission Playground has a new synthetic soccer field. The original scope is complete and was Open to the Public September 15, 2012. A second phase, including repair to the pool building and systems, is now complete and was **Open to the Public in August 2013**.

Project Schedule

	Start	Finish
Baseline/Original	Aug 2008	May 2011
Actual	Mar 2009	Aug 2013

Project Budget

Original Budget	\$7,500,000
Current Budget	\$9,357,000
Current Projected	\$9,357,000
Actual Expenditures	\$9,309,118



Project Status Summaries

Palega Playground

Project Location: 500 Felton Street

Project Manager: Toks Ajike

toks.ajike@sfgov.org; (415) 581-2543

Project Description: Renovation of the Palega Playground included repair and/or renovation of the recreation center, fields, courts, and children's play area; improvements to the pathway network; upgrades to the irrigation and lighting systems; modifications to the site to remove barriers and improve accessibility, and overall reconditioning of the park landscape. Project scope also included a building addition to meet the growing demands for indoor recreational space. The project is complete and was **Open to the Public in November 2013**.

Project Schedule

	Start	Finish
Baseline/Original	Aug 2008	May 2012
Actual	Jul 2009	October 2013

Project Budget

Original Budget	\$21,200,000
Current Budget	\$18,200,000
Current Projected	\$18,200,000
Actual Expenditures	\$16,752,468



Cayuga Playground

Project Location: 1898 Cayuga Street

Project Manager: Marvin Yee;

marvin.yee@sfgov.org; (415) 581-2541

Project Description: The project scope includes site reconfiguration; a new clubhouse, playground, and courts; and field renovation. Unique wooden sculptures found throughout the park have been inventoried and catalogued. BART is contributing \$1.355 million, which is the value to restore park features that will be impacted during BART's Emergency Safety Program (ESP) work in Cayuga Park. This project is complete and **Open to the Public in August 2013**.

Project Schedule

	Start	Finish
Baseline/Original	Aug 2008	May 2011
Actual	Feb 2009	July 2013

Project Budget

Original Budget	\$7,300,000
Current Budget	\$9,410,035
Current Projected	\$9,410,035
Actual Expenditures	\$9,249,945



Project Status Summaries

McCoppin Square

Project Location: 24th Avenue and Taraval Street

Project Manager: Meghan Tiernan;

meghan.tiernan@sfgov.org; (415) 581-2557

Project Description: The project scope included relocation of children's play area, installation of new play equipment, renovation of athletic fields and tennis court; restoration of existing roads and pathways; upgrades to the irrigation and lighting systems; site modifications to remove barriers and improve ADA accessibility, overall reconditioning of the park landscape, and installation of a new restroom building. The project started construction in October 2010 and was **Open to the Public in October 2011**.



Project Schedule

	Start	Finish
Baseline/Original	Oct 2008	Jul 2011
Actual	Jan 2009	Oct 2011

Project Budget

Original Budget	\$5,300,000
Current Budget	\$3,800,000
Current Projected	\$3,800,000
Actual Expenditures	\$3,567,851

Sunset Playground

Project Location: 2201 Lawton Street

Project Manager: Dan Mauer;

dan.mauer@sfgov.org; (415) 581-2542

Project Description: The project scope included the repair and renovation of the recreation center/ gymnasium, children's play area, fields, and courts; restoration of existing pathways; upgrades to the irrigation and lighting systems; modifications to the site to remove barriers and improve accessibility, and overall reconditioning of the park landscape. Construction started in June 2011 and the renovated field opened on March 1, 2012. Remainder of the project is complete and was **Open to the Public in November 2012**.



Project Schedule

	Start	Finish
Baseline/Original	Aug 2008	Jan 2012
Actual	Feb 2009	Nov 2012

Project Budget

Original Budget	\$13,700,000
Current Budget	\$13,700,000
Current Projected	\$13,700,000
Actual Expenditures	\$13,724,015

Project Status Summaries

Fulton Playground

Project Location: 855 27th Avenue

Project Manager: Pauline Araica;

pauline.araica@sfgov.org; (415) 581-2558

Project Description: Fulton Playground project included the rehabilitation of the clubhouse (which has been designated a historical resource by the Planning Department), renovation of the children's play areas and sport courts, and site improvements. The project is complete and was **Open to the Public in October 2012**.

Project Schedule

	Start	Finish
Baseline/Original	Aug 2008	Jan 2011
Actual	Feb 2009	Oct 2012

Project Budget

Original Budget	\$4,200,000
Current Budget	\$4,935,000
Current Projected	\$4,935,000
Actual Expenditures	\$4,916,319



Mission Dolores Park – Helen Diller Playground

Project Location: Dolores Street and 19th Avenue

Project Manager: Mary Hobson;

mary.hobson@sfgov.org; (415) 581-2575

Project Description: The Recreation and Parks Department collaborated with the Friends of Dolores Park Playground and the Urban Resource Systems, Inc. in the total renovation of the play area. Additionally, RPD partnered with the Mercer Foundation and Friends of Dolores Park Playground for a generous donation of \$1.5 million to fund the project. The playground is complete and was **Open to the Public in March 2012**.

Project Schedule

	Start	Finish
Baseline/Original	Dec 2007	Apr 2010
Actual	Jan 2008	Mar 2012

Project Budget

Original Budget	\$3,250,000
Current Budget	\$3,647,885
Current Projected	\$3,647,885
Actual Expenditures	\$3,550,167



Project Status Summaries

Mission Dolores Park Renovation

Project Location: Dolores Street and 19th Avenue

Project Manager: Jake Gilchrist;

jacob.gilchrist@sfgov.org; (415) 581-2561

Project Description: Currently in the Construction phase on the northern half of the site, called Phase 1, the full project scope includes the replacement and/or renovation of the clubhouse, restrooms, picnic area, sport courts, pathways, irrigation, drainage, lighting, and landscape planting. The project will be constructed and delivered in two phases, with the first scheduled to be complete in Fall 2014 and the second in Summer 2015.



Project Schedule

	Start	Finish
Baseline/Original	Oct 2009	Mar 2013
Actual	May 2010	June 2015

Project Budget

Original Budget	\$11,700,000
Current Budget	\$16,597,175
Current Projected	\$16,597,175
Actual Expenditures	\$4,285,979

Cabrillo Playground

Project Location: 855 27th Avenue

Project Manager: Pauline Araica;

pauline.araica@sfgov.org; (415) 581-2558

Project Description: Cabrillo Playground project includes the repair and/or renovation of the clubhouse, children's play area, picnic areas, sport courts, upgrades to infrastructure, accessibility improvements, and overall reconditioning of the park landscape. The project is complete and was **Open to the Public in August 2013**.



Project Schedule

	Start	Finish
Baseline/Original	Oct 2009	Aug 2012
Actual	Jun 2010	August 2013

Project Budget

Original Budget	\$4,500,000
Current Budget	\$4,500,000
Current Projected	\$4,500,000
Actual Expenditures	\$4,498,830

Project Status Summaries

Glen Canyon Park

Project Location: Elk Street and O'Shaughnessy Blvd.

Project Manager: Karen Mauney-Brodek;

karen.mauney-brodek@sfgov.org; (415) 575-5601

Project Description: RPD partnered with the Trust for Public Land to host a series of six community improvement workshops in order to determine the project to be funded by the 2008 Clean and Safe Neighborhood Parks Bond. After this extensive community outreach process, the project scope will include the following areas: a larger welcoming entry with a vehicular drop-off on Elk Street, a pedestrian path and landscaping, a new expanded children's playground, and new tennis courts. Additionally, there will be minor repairs to the Recreation Center and an exteriorly accessible restroom will be provided to comply with the Americans with Disabilities Act. This project is substantially complete and will be **Open to the Public March 15, 2014**.



Project Schedule

	Start	Finish
Baseline/Original	Oct 2009	Jan 2013
Actual	May 2010	March 2014

Project Budget

Original Budget	\$5,800,000
Current Budget	\$5,800,000
Current Projected	\$5,800,000
Actual Expenditures	\$5,754,982

Lafayette Park

Project Location: Gough Street at Washington Street

Project Manager: Mary Hobson

mary.hobson@sfgov.org; (415) 581-2575

Project Description: The project scope will include the renovation the children's play area, restroom, picnic area, and courts; restoration of roads and pathways; upgrades to the infrastructure including lighting and irrigation, modifications to the site to remove barriers and improve accessibility, and overall reconditioning of the park landscape. The project is complete and was **Open to the Public in June 2013**.

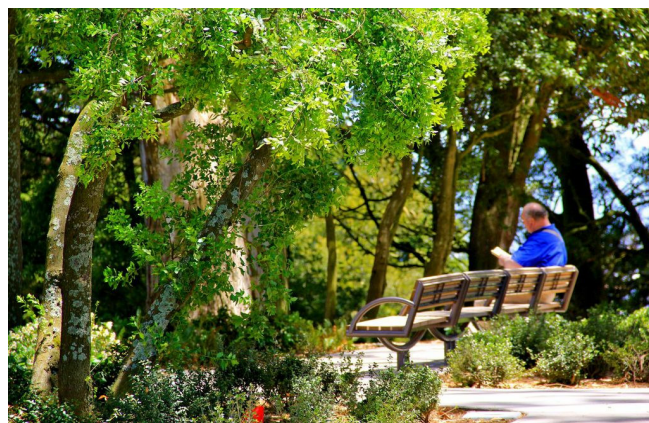

Project Schedule

	Start	Finish
Baseline/Original	Dec 2009	May 2013
Actual	Jun 2010	June 2013

Project Budget

Original Budget	\$10,200,000
Current Budget	\$10,400,000
Current Projected	\$10,400,000
Actual Expenditures	\$10,211,891

Project Status Summaries

Raymond Kimbell Playground

Project Location: Geary Blvd. and Steiner Street

Project Manager: Dan Mauer

dan.mauer@sfgov.org; (415) 581-2542

Project Description: The project scope will include the replacement of restroom and locker room facilities, the children's play area, and lawns; restoration of pathways; upgrades to the infrastructure including lighting and irrigation, modifications to the site to remove barriers and improve accessibility, and overall reconditioning of the park landscape. The athletic fields were renovated in partnership with the City Fields Foundation and opened in June 2010.



Project Schedule

	Start	Finish
Baseline/Original	Feb 2010	Nov 2012
Actual	Jul 2010	June 2015

Project Budget

Original Budget	\$3,300,000
Current Budget	\$4,100,000
Current Projected	\$4,100,000
Actual Expenditures	\$662,244

• **Citywide Programs**

Restroom Repair And Replacement Program

Project Manager: Marvin Yee

marvin.yee@sfgov.org; (415) 581-2541

The Restroom Repair and Replacement program funds the construction, repair, and renovation of restroom facilities. Many of the city park's restrooms are old, need repair, and are poorly designed for maintenance and proper supervision. Per the 2008 Bond Report, the Recreation & Parks Commission appointed a Restroom Taskforce to work with staff and the community to develop recommendations for which restrooms should be renovated, replaced or added. The Restroom Taskforce developed a plan to renovate or replace 18-21 restrooms, depending on costs. To date, 13 restrooms are complete and Open to the Public, one is in construction, one in bid/award, and four in planning or design.



Project Status Summaries

Park Playfields Repair And Reconstruction Program

Project Manager: Dan Mauer

dan.mauer@sfgov.org; (415) 581-2542

The Playfields Initiative is a public-private partnership between the City Fields Foundation and the Recreation and Parks Department. The goal of the program is to address the chronic shortage of athletic fields in San Francisco and equitably provide sports facilities for youth and adult leagues, school teams, physical education classes and informal neighborhood play. To date, the program has renovated 6 parks increasing the overall play hours by 31,000 hours. (62,000 overall hours with reorganization to our field permits system)

Using a new generation of synthetic turf, select athletic fields across the City have been completely overhauled with field drainage, goals and backstops/fencing, bleachers, garbage cans, signage, and field lights.

The 2008 Clean and Safe Neighborhood Parks Bond will provide \$8.5 million in funding which will be coupled with private dollars to renovate the four athletic fields at the Beach Chalet in Golden Gate Park, as well as the athletics fields at Minnie Lovie Recreation Center. The overall philanthropic funding match for this program is 1 to 1 with a current expended gift of over \$14 M to date.



Park Forestry Program

Project Manager: Steven Korovesis

steven.korovesis@sfgov.org; (415) 581-2547

The Recreation & Park Department's forest is estimated to contain roughly 131,000 trees. It has not received major physical attention since the original planting. Though one of the most important elements of our urban parks is the trees, the first a thorough assessment and plan for the care, repair and planting of new trees was funded in the 2008 Bond..

Under this program, the Recreation and Park Department engaged forestry professionals to identify sites that pose the greatest potential of tree failure. Using data for facility usage and tree failure history, the forestry team created a prioritized list for all RPD facilities that was reviewed and approved by the Recreation and Parks Commission in February 2010. The bond program will initially address the highest priority sites. The scope includes assessing trees with accepted urban forestry techniques such as the hazard rating system, and packaging tree pruning and removal work into contracts for public bid.



Project Status Summaries

Park Trail Reconstruction Program

Project Manager: Melinda Stockmann

melinda.stockmann@sfgov.org; (415) 581-2548

Nature trails in San Francisco's parks are in poor shape – frequently in need of erosion control and other improvements to the condition of the surrounding landscape. 2008 Clean and Safe NP Bond funds will improve access and opportunities to walk and hike, allowing residents to better enjoy and experience nature and vistas in San Francisco parks.

In order to prioritize projects, staff worked with Recreation and Parks Department Commission, PROSAC, and other stakeholders to develop objective criteria to develop a prioritized list of parks for improvement. Criteria focused on three areas equally 1) Access, 2) Conservation and 3) Safety. The prioritization developed focuses on improvements at 10 sites to receive capital work through this bond. The list of sites for the Bond's Trails Program was presented to and approved by the RPD Commission on June 4th, 2009. With this approval, project staff began to focus on the specific design and community process for each trail site.



Figure 1: Grandview Trail, completed early 2012

Community Opportunity Fund Program

Project Manager: Jake Gilchrist

jacob.gilchrist@sfgov.org; (415) 581-2561

The Community Opportunity Fund Program provides neighborhoods, community groups and people who love and care for their parks an opportunity to receive improvements for a Recreation & Parks Department park they nominate. The program promotes increased stewardship of parks by encouraging volunteer and fundraising partnerships. The program is separated into 3 application and award rounds. Round 1 of the Community Opportunity Fund began in late June 2010, Round 2 in March 2011, and Round 3 March 2012. All COF awards have now been completed, and new applicants are directed to the 2012 Bond COF Program. Round 4 applications are due in April 2014.



Community Opportunity Fund Program

Project Schedules

Major Waterfront Park Projects

Pier 43 Bay Trail Link: *SUBSTANTIALLY COMPLETE*

Project Location: Powell to Taylor Streets – Embarcadero

Project Manager: Steven Reel, steven.reel@sfpport.org; (415) 274-0574

Located along the Bay north of the Pier 43 Arch, the site previously consisted of condemned piers and partially closed sidewalk due to a failing seawall. The project created a new waterfront open space destination featuring a public promenade along the water's edge. The project removed 70,000 SF of pier, replaced 520 linear feet of seawall, constructed 20,600 SF of pile supported concrete wharf, and reconstructed sidewalks, curbs and gutters.

During the entitlement process, scope was added to the project for additional wharf area (requested by the Bay Conservation and Development Commission, or BCDC), for ADA improvements near Pier 45, and for security lighting. The additional scope caused a delay of 1 month and increased the estimated cost by \$2 M. To fund the additional scope, Port used capital funds and grants from the Association of Bay Area Governments (ABAG) and the Federal Department of Homeland Security (DHS).

This Project is complete and open to the public.



Budget	GO Bond	Total Funds
Original Budget	\$7,677,800	\$7,808,263
Current Approved Budget	\$7,677,800	\$10,191,508
Actual Expenditures To Date	\$7,587,499	\$9,921,768

Schedule	Planning	Design	Construction	Completion
Original	March 2008	November 2009	January 2011	June 2012
Current Forecast or Actual	July 2008	December 2009	July 2011	November 2012

Project Schedules

Brannan Street Wharf: *SUBSTANTIALLY COMPLETE*

Project Location: Embarcadero at Brannan Street

Project Manager: Steven Reel, steven.reel@sfpport.org; (415) 274-0574

Located along the Bay in the South Beach neighborhood, the project created a 57,000 SF public open space wharf along approximately 850 linear feet of waterfront which was previously inaccessible due to condemned wharf and pier structures. Features, as recommended by a citizen's advisory committee, include a raised lawn, public float, seating, and interpretive exhibits.

Preliminary engineering studies indicated the need for unexpected repairs and strengthening of a portion of the existing seawall; revealed deteriorated structure supporting a portion of The Embarcadero Promenade; uncovered ground instability within the new wharf area; and identified complexity in the removal of the existing Pier 36 caissons. Recognizing a funding shortfall, the Port was successful in obtaining \$4.7M of federal funds specifically for pier removal. The funding required pier removal to be delivered as a separate project lead by the US Army Corps of Engineers and triggered additional environmental review (NEPA) resulting in a 1 year schedule delay.

Even with the additional funding, the public float had to be excluded from the project to resolve the budget deficit.

Construction of the wharf commenced in December 2011. The wharf is substantially complete and open to the public.



Budget	GO Bond	Total Funds
Original Budget	\$2,941,050	\$20,544,030
Current Approved Budget	\$2,941,050	\$26,246,271
Actual Expenditures To Date	\$2,941,050	\$24,908,683

Schedule	Planning	Design	Construction	Completion
Original	January 2008	July 2009	September 2010	August 2012
Current Forecast or Actual	July 2008	October 2009	December 2011	July 2013

Project Schedules

Blue Greenway Planning & Design Guidelines: *SUBSTANTIALLY COMPLETE*

Project Location: The Southern Waterfront, running from Mission Creek to Pier 98

Project Manager: David Beaupre, david.beaupre@sfport.org; (415) 274-0539

The Blue-Greenway Design standards evolved through the community planning process to be more than just design guidelines. Stakeholders, the Port Commission and City agency partners agreed that to be more useful, the process and results required more planning to understand the opportunities along the entire Blue Greenway. However, as the scope was refined, it was determined that it would be difficult to develop design standards without a better understanding of the entire scope of potential projects within the Blue-Greenway. Therefore the planning process was expanded to include the identification of open space opportunities, identification of programming (uses) options, project cost estimates and the development of an implementation strategy to improve the Blue Greenway, including project prioritization.

The Port hosted a series of community meetings and the guidelines were substantially complete in September of 2013.



Budget	GO Bond	Other Funds	Total Funds
Original Budget*	\$2,533,250	\$0	\$2,533,250
Current Approved Budget	\$325,472	\$0	\$325,472
Actual Expenditures To Date	\$325,472	\$0	\$325,472

Schedule	Planning	Design	Construction	Completion
Original	March 2008	N/A	N/A	August 2009
Current Forecast or Actual	May 2008	N/A	N/A	September 2013

* The original budget for this project included funding for signage and site furnishings; however, these elements have since been separated into a new project called "Blue Greenway Signage and Site Furnishings" with a distinct budget and schedule.

Project Schedules

Bayfront Park: *SUBSTANTIALLY COMPLETE*

Project Location: Terry A. Francois Street, between South Street and Mariposa

Project Manager: David Beaupre, david.beaupre@sport.org; (415) 274-0539

This project along the Blue Greenway included the removal of deteriorated piers and wharves, and reconstruction of 1,200 linear feet of shoreline to allow Bayfront Park to be constructed to the Bay's edge. The shoreline project included the installation of a temporary 8' wide mixed use pathway to allow the public to access the shoreline while the Park was under construction. This project is complete and opened to the public in February of 2012.



Budget	GO Bond	Other Funds	Total Funds
Original Budget	\$2,950,000	\$0	\$2,950,000
Current Approved Budget	\$2,330,367	\$0	\$2,330,367
Actual Expenditures To Date	\$2,330,367	\$0	\$2,330,367

Schedule	Planning	Design	Construction	Completion
Original	January 2008	January 2009	March 2010	February 2011
Current Forecast or Actual	January 2008	January 2009	September 2011	February 2012

Project Schedules

Heron's Head Park: *SUBSTANTIALLY COMPLETE*

Project Location: Jennings Street and Cargo Way

Project Manager: David Beaupre, david.beaupre@sfpport.org; (415) 274-0539

This Blue Greenway project included an expansion of the existing Heron's Head Park by approximately an acre, by: a) converting a paved area into a meadow, and planter areas; b) organizing the service and parking areas; c) creating a dog run; d) installing picnic tables and seating areas, new lighting and bicycle amenities; e) adding park signage; f) including new sites for public art; g) creating a defined pedestrian circulation area; and h) adding a landscape based storm-water treatment system. The design is consistent with the sustainable natural theme of the existing park.

The original budget established was based upon a smaller park opportunity site, in preparing the design and working through the community review process the project site was enlarged. The GO Bond funding strategy for Blue Greenway Parks accommodated opportunity for projects to expand or consolidate through the planning process. This project was completed and opened to the public in September 2012.



Budget	GO Bond	Total Funds
Original Budget	\$550,000	\$550,000
Current Approved Budget	\$2,351,000	\$2,397,861
Actual Expenditures To Date	\$2,351,000	\$2,397,861

Schedule	Planning	Design	Construction	Completion
Original	January 2009	October 2009	December 2010	May 2011
Current Forecast or Actual	January 2009	March 2010	December 2011	September 2012

Project Schedules

Tulare Park – POSTPONED INDEFINITELY

Project Location: Islais Creek shoreline, north side between Illinois and Third Streets

Project Manager: David Beaupre, david.beaupre@sfpport.org; (415) 274-0539

Across Islais Creek from the future site of the Bayview Gateway, Tulare Park is an existing Blue Greenway Park that was originally constructed in the early 1970s and is in need of major improvements including upgrades required under the Americans with Disabilities Act (ADA). During final design of the Tulare Park improvements, it was determined that grading required to create the ADA accessible path would pose significant risk of damage to both the San Francisco Public Utilities Commission force main and the existing retaining wall running throughout the site. After studying alternatives, a pedestrian bridge was chosen as the most cost effective solution to create an accessible pathway.

Construction quotes for the proposed Bayview Gateway and Tulare Park projects were significantly beyond the existing budgets for each project. The Port is currently pursuing strategies to redirect the Tulare Park funding to the higher priority Bayview Gateway project, subject to Board of Supervisors approval. The approved budget shown below will be updated after the appropriate approvals have been granted. If approved, the Tulare Park project would be postponed indefinitely until new funds and a more cost effective approach could be identified.

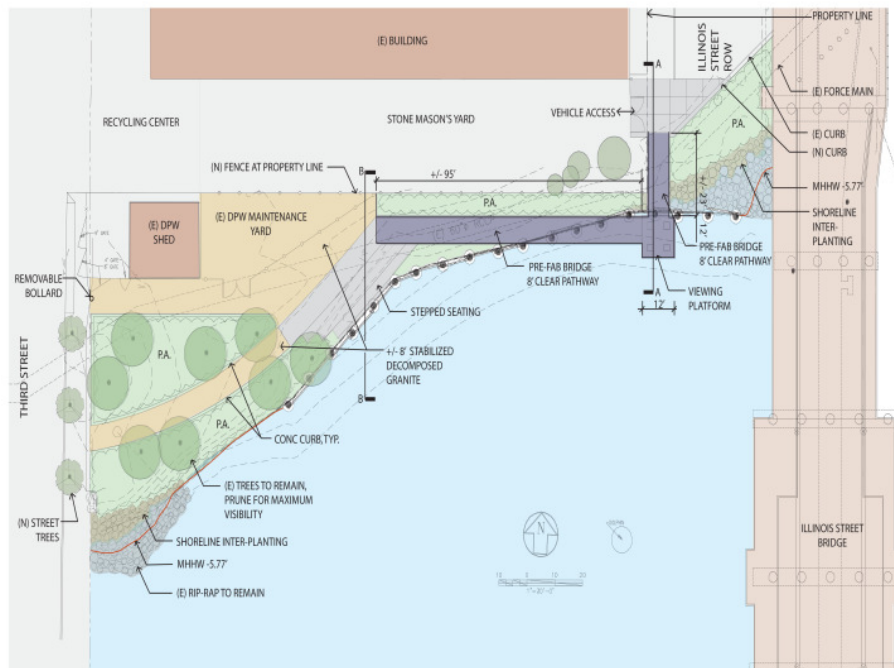

TULARE PARK CONCEPT PLAN
Port of San Francisco

July, 2011
SFPDW Landscape Architecture

Budget	GO Bond	Other Funds	Total Funds
Original Budget	\$585,000	\$275,000	\$860,000
Current Approved Budget	\$1,029,625	\$0	\$1,029,625
Actual Expenditures To Date	\$330,567	\$0	\$330,567

Schedule	Planning	Design	Construction	Completion
Original	April 2011	October 2012	October 2012	December 2013
Current Forecast or Actual	April 2011	October 2012	Pending review	Pending review

Project Schedules

Blue Greenway Public Art

Project Location: Blue Greenway Mission Creek and Heron's Park

Project Manager: David Beaupre, david.beaupre@sfort.org; (415) 274-0539

Working with the SF Arts Commission, the Port identified the Bayview Gateway site as the appropriate site and location for the Port's Art Enrichment Project.

The SF Arts Commission released a call for artist to submit qualifications for the project in the fall of 2014 and expects to select 3 artists to submit proposals. The final artist will be selected in the summer of 2014 with fabrication and installation to begin in late 2014.



Budget	GO Bond	Total Funds
Original Budget	\$684,000	\$684,000
Current Approved Budget	\$684,000	\$684,000
Actual Expenditures To Date	\$27,057	\$27,057

Schedule	Planning	Design	Construction	Completion
Original	April 2011	March 2012	May 2013	August 2013
Current Forecast or Actual	July 2011	February 2014	October 2014	June 2015

Project Schedules

Crane Cove Park

Project Location: Nineteenth and Illinois Street

Project Manager: David Beaupre, david.beaupre@sfport.org; (415) 274-0539

Crane Cove Park is an approximately 9 acre Blue Greenway waterfront park located in the Central Waterfront generally between 19th and Mariposa Streets east of Illinois Street. Initial park concepts include shoreline cleanup and stabilization, restoration of historic cranes, historic interpretation, bay access, and a facility for human powered boats. The total cost for the entire project is expected to be \$45 million dollars, which is greater than the current available funding. As a result, the project will be phased as funding is secured. Available funding for the 1st phase of the project is \$21,324,148 million, including (a) 10,024,148 in 2008 Clean and Safe Neighborhood Park G.O. Bonds, (b) \$8,000,000 from 2012 Clean and Safe Neighborhood Parks G.O. Bonds, and (c) \$3,300,000 in other Port funds.

This Blue Greenway Project benefits from significant planning conducted through the development of the Port's Pier 70 Preferred Master Plan and the Blue Greenway Planning and Design Guidelines community planning process.

A draft Park Master plan was reviewed with the Port Commission and Port's Waterfront Design Review Board in December of 2012 and January, June, September, and December of 2013. The Port has created a web site to allow the public to review work products and track the project status at www.sfport.com/cranecovepark.

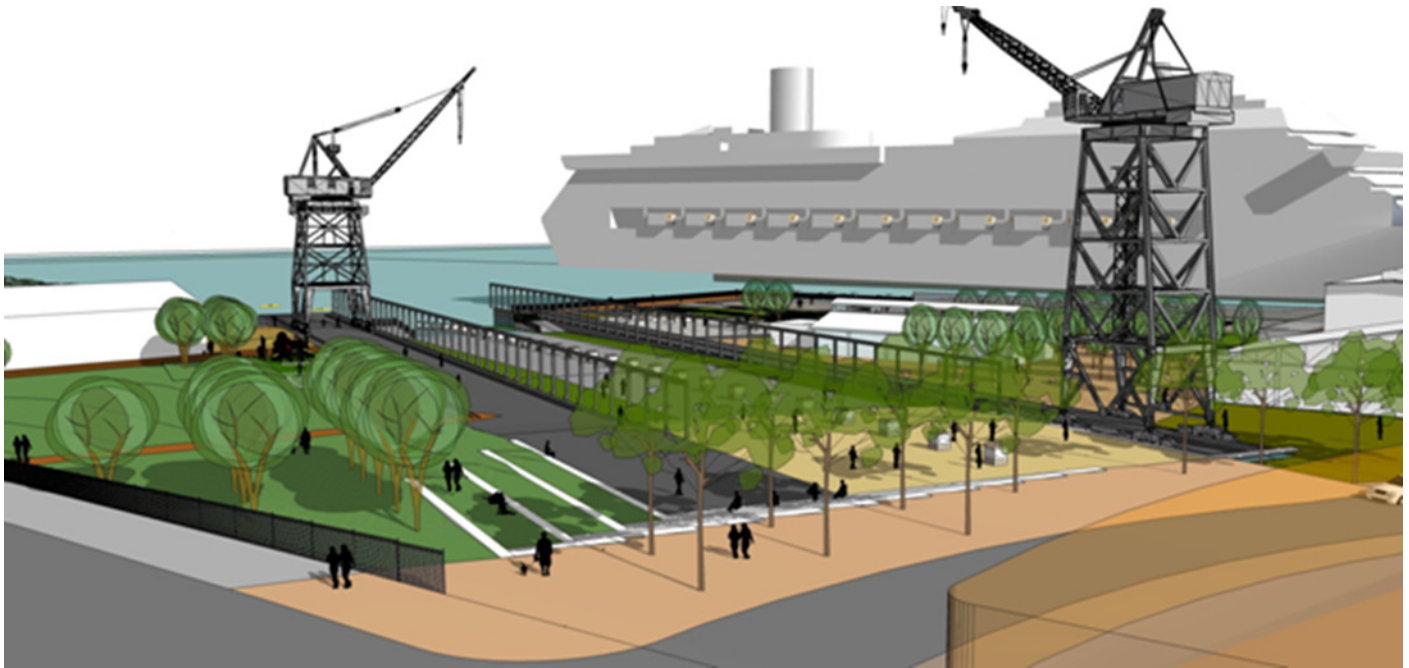

Budget	GO Bond	Total Funds
Original Budget	\$10,024,148	\$11,124,148
Current Approved Budget	\$10,024,148	\$21,324,148
Actual Expenditures To Date	\$604,602	\$604,602

Schedule	Planning	Design	Construction	Completion
Original	September 2011	March 2013	February 2014	February 2015
Current Forecast or Actual	September 2011	March 2014	January 2016	May 2017

Project Schedules

Blue Greenway Signage and Site Furnishings

Project Location: Blue Greenway Linking Streets between Mission Creek and Heron's Head Park

Project Manager: David Beaupre, david.beaupre@sfpport.org; (415) 274-274-0539

The Blue Greenway is the City's project to improve the City's southerly portion of the 500 mile, 9-county, region-wide Bay Trail. Uniquely, the trail does not follow one continuous waterfront path or have consistent water views to serve as a navigational tool for users; users have to consciously find transitions and make decisions in order to stay on the system. Additionally, because the Blue Greenway is in its early inception, it lacks recognition by the general public. In order to help build identity and allow users to find their way along the system, the Port, working with our stakeholders, has developed a signage and way-finding program to build identity and provide users orientation to find their way along the system. The program includes large customized signs (as conceptualized in the diagram) which include navigational information.

The contract to construct and install these custom signs went out to bid in late March 2013 and a contract was awarded with Port Commission approval. In addition to signage, furnishings such as benches and waste receptacles will be provided at the sign sites where practicable.

This Project went out to bid in late March 2013, the Port commission approved the award of the bid and the signage portion of the project will be substantially completed by April 2014, with the remaining minor site improvements completed in Sept 2014.

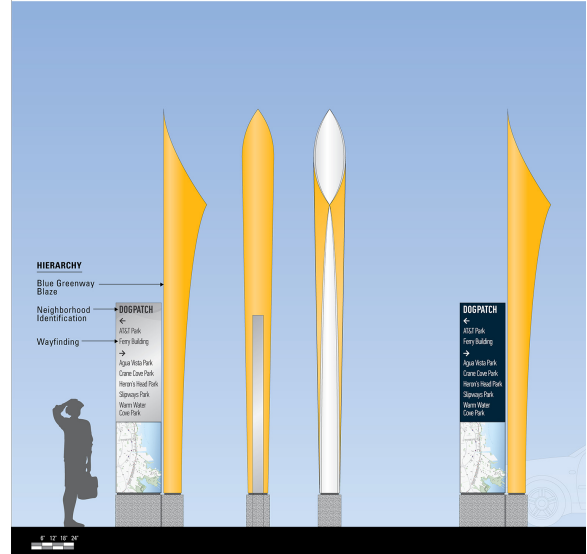

Budget	GO Bond	Other Funds	Total Funds
Original Budget	\$434,000	n/a	\$434,000
Current Approved Budget	\$998,911	\$0	\$998,911
Actual Expenditures To Date	\$485,431	\$0	\$485,431

Schedule	Planning	Design	Construction	Completion
Original	June 2011	January 2012	January 2013	August 2013
Current Forecast or Actual	April 2011	January 2012	June 2013	September 2014

Project Schedules

Bayview Gateway

Project Location: Islais Creek shoreline, south side between Illinois and Third Streets

Project Managers: David Beaupre, david.beaupre@sfport.org; (415) 274-0539 (Planning)
Steven Reel, steven.reel@sfport.org; (415) 274-0574 (Engineering)

The Bayview Gateway Project will create a new one acre public open space along the southern bank of Islais Creek in San Francisco's southeast waterfront. The project site is bound by Islais Creek on the north, Cargo Way on the south, 3rd Street on the west, and Illinois Street on the east. This area was reclaimed from the Bay in the 1900s and served as a working waterfront with a timber wharf and shed. The shed was removed in the early 1980s leaving an asphalt covered lot. The project will demolish the existing timber wharf, rehabilitate the seawall, and transform the asphalt lot into a public park with walkways, plaza spaces and green spaces from which to enjoy the Bay. In addition, the project will serve as both a gateway to and an amenity for the Bayview neighborhood.

Construction estimates early in the design phase indicated the project would cost 13% more than the current budget. Value engineering measures were taken to simplify the design with some success. However, additional project scope was added for unanticipated right of way improvements including a new crosswalk at 3rd Street, modifications and repairs to the adjacent sidewalks, and more extensive roadway and traffic signal work at 3rd Street and Cargo Way.

Construction quotes for the proposed Bayview Gateway and Tulare Park projects were significantly beyond the existing budgets for each project. The Port is currently pursuing strategies to redirect the Tulare Park funding to the higher priority Bayview Gateway project, subject to Board of Supervisors approval. The approved budget shown below will be updated after the appropriate approvals have been granted.



Budget	GO Bond	Other Funds	Total Funds
Original Budget	\$3,282,125	\$0	\$3,282,125
Current Approved Budget	\$3,926,750	\$0	\$3,926,750
Actual Expenditures To Date	\$347,922	\$0	\$347,922

Schedule	Planning	Design	Construction	Completion
Original	September 2011	March 2012	October 2012	August 2013
Current Forecast or Actual	September 2011	March 2012	August 2014	May 2015

Timeline and Schedule
Neighborhood Parks - as of June 30, 2014

LEGEND

	INITIATION / PLANNING
	DESIGN / BID & AWARD
	CONSTRUCTION

						SCHEDULE		2008				2009				2010				2011				2012				2013				2014																																																			
						DIST	PHASE	AMOUNTS		START	FINISH	J	F	M	A	M	J	J	A	S	O	N	D	J	F	M	A	M	J	J	A	S	O	N	D	J	F	M	A	M	J	J	A	S	O	N	D																																				
												3rd Qtr	4th Qtr	1st Qtr	2nd Qtr	3rd Qtr	4th Qtr	1st Qtr	2nd Qtr	3rd Qtr	4th Qtr	1st Qtr	2nd Qtr	3rd Qtr	4th Qtr	1st Qtr	2nd Qtr	3rd Qtr	4th Qtr	1st Qtr	2nd Qtr	3rd Qtr	4th Qtr	1st Qtr	2nd Qtr	3rd Qtr	4th Qtr	1st Qtr	2nd Qtr	3rd Qtr	4th Qtr	1st Qtr	2nd Qtr	3rd Qtr	4th Qtr	1st Qtr	2nd Qtr																																				
NEIGHBORHOOD PARKS																																																																																			
PHASE 1																																																																																			
Chinese Recreation Center																																																																																			
Original/Baseline						3	Closeout	\$21,173,785	Pre-2008	Sep-10		\$5,510,978				\$15,193,416																																																																			
Current Approved								\$21,173,785	Jan-06	Dec-11		\$5,510,978				\$15,193,416																																																																			
Actual								\$19,403,517	Jun-08	Jul-12		\$361,589				\$3,188,342				\$15,853,585.82																																																															
Mission Playground																																																																																			
Original/Baseline						8	Closeout	\$7,500,000	Aug-08	May-11		\$323,300				\$654,700				\$6,522,000																																																															
Current Approved								\$7,500,000	Aug-08	Oct-11		\$323,300				\$654,700				\$6,522,000																																																															
Actual								\$9,309,118	Mar-09	Aug-13		\$221,453				\$1,106,953				\$7,980,712																																																															
Palega Playground Renovation																																																																																			
Original/Baseline						9	Closeout	\$21,200,000	Aug-08	May-12		\$701,000				\$2,005,300				\$18,493,700																																																															
Current Approved								\$18,200,000	Aug-08	Nov-12		\$701,000				\$2,005,300				\$15,493,700																																																															
Actual								\$16,752,468	Jul-09	Oct-13						\$476,621				\$1,603,190				\$14,672,657																																																											
Cayuga Playground Renovation																																																																																			
Original/Baseline						11	Closeout	\$7,300,000	Aug-08	May-11		\$316,000				\$629,000				\$6,355,000																																																															
Current Approved								\$7,300,000	Aug-08	Jun-12		\$316,000				\$629,000				\$6,355,000																																																															
Actual								\$9,249,945	Feb-09	Aug-13						\$270,979				\$1,488,668				\$7,490,298																																																											
McCoppin Square Renovation																																																																																			
Original/Baseline						4	Closeout	\$5,300,000	Oct-08	Jul-11		\$261,700				\$432,500				\$4,605,800																																																															
Current Approved								\$5,300,000	Aug-08	Dec-11		\$261,700				\$432,500				\$4,605,800																																																															
Actual								\$3,567,851	Jan-09	Nov-11						\$164,934				\$302,000				\$3,100,917																																																											
Sunset Playground Renovation																																																																																			

Initiation/ Planning Design/ Bid & Award Construction/ Close Out			GO Bond Budget			Start Date			End Date			2008				2009				2010				2011				2012				2013				2014				2015				2016				2017															
												J F M A M J J A S O N D				J F M A M J J A S O N D				J F M A M J J A S O N D				J F M A M J J A S O N D				J F M A M J J A S O N D				J F M A M J J A S O N D				J F M A M J J A S O N D				J F M A M J J A S O N D				J F M A M J J A S O N D																			
												Q3	Q4	Q1	Q2	Q3	Q4	Q1	Q2	Q3	Q4	Q1	Q2	Q3	Q4	Q1	Q2	Q3	Q4	Q1	Q2	Q3	Q4	Q1	Q2	Q3	Q4	Q1	Q2	Q3	Q4	Q1	Q2	Q3	Q4	Q1	Q2	Q3	Q4	Q1	Q2												
PIER 43 BAY TRAIL LINK																																																															
Original	\$7,677,800	March 2008	June 2012																																																												
Current	\$7,677,800	July 2008	November 2012																																																												
BRANNAN STREET WHARF																																																															
Original	\$2,941,050	January 2008	August 2012																																																												
Current	\$2,941,050	July 2008	July 2013																																																												
BLUE GREENWAY PLANNING & DESIGN GUIDELINES																																																															
Original	\$2,533,250	March 2008	August 2009																																																												
Current	\$336,000	May 2008	September 2013																																																												
BAYFRONT PARK																																																															
Original	\$2,950,000	January 2008	February 2011																																																												
Current	\$2,950,000	January 2008	February 2012																																																												
HERON'S HEAD PARK																																																															
Original	\$550,000	January 2009	May 2011																																																												
Current	\$2,351,000	January 2009	September 2012																																																												
TULARE PARK																																																															
Original	\$585,000	April 2011	December 2013																																																												
Current	\$1,130,580	April 2011	January 2015																																																												
BLUE GREENWAY PUBLIC ART																																																															
Original	\$684,000	April 2011	August 2013																																																												
Current	\$684,000	July 2011	June 2015																																																												
CRANE COVE PARK																																																															
Original	\$10,024,148	September 2011	February 2015																																																												
Current	\$10,024,148	September 2011	May 2017																																																												
BLUE GREENWAY SIGNAGE AND SITE FURNISHINGS																																																															
Original	\$434,000	June 2011	August 2013																																																												
Current	\$989,725	April 2011	September 2014																																																												
BAYVIEW GATEWAY																																																															
Original	\$3,282,125	September 2011	August 2013																																																												
Current	\$3,282,125	September 2011	May 2015																																																												

**2008 Clean & Safe Neighborhood Park G.O. Bond
Program Budget Reports - Revenues as of 6/30/14**

PROGRAMS	CURRENT/ FORECAST BUDGET	2008 CSP BONDS	2000 NP BONDS	OPEN SPACE FUNDS	REVENUE BONDS	GENERAL FUND	GIFTS	GRANTS	BART FUNDS	OTHER PORT FUNDS	TOTAL SOURCES
<u>NEIGHBORHOOD PARKS</u>											
1 Cabrillo Playground Renovation	4,500,000	4,500,000	-	46,591	-	-	-	-	-	-	4,546,591
11 Cayuga Playground	8,699,256	7,300,000	-	-	-	-	-	710,779	1,399,256	-	9,410,035
3 Chinese Recreation Center	20,487,430	13,124,924	-	-	6,278,592	-	-	-	-	-	19,403,517
1 Fulton Playground	4,620,000	4,935,000	-	-	-	-	-	-	-	-	4,935,000
8 Glen Canyon Park Renovation	5,800,000	6,191,000	-	-	-	-	-	-	-	-	6,191,000
2 Lafayette Park Renovation	10,200,000	10,200,000	-	-	-	-	200,000	-	-	-	10,400,000
4 McCoppin Square Playground	5,300,000	3,800,000	-	-	-	-	-	-	-	-	3,800,000
8 Mission Dolores Park Renovation	11,700,000	16,500,000	-	40,000	97,175	-	-	-	-	-	16,637,175
8 Mission Dolores Park-Helen Diller Playground	2,991,441	1,589,930	52,441	-	191,096	248,480	1,468,220	-	-	-	3,550,167
8 Mission Playground	7,500,000	9,317,000	-	-	-	-	40,000	-	-	-	9,357,000
9 Palega Playground	21,200,000	18,200,000	-	-	-	-	-	-	-	-	18,200,000
5 Raymond Kimbell Playground Renovation	3,300,000	4,100,000	-	-	-	-	-	-	-	-	4,100,000
4 Sunset Playground	13,700,000	13,900,000	-	-	-	-	-	15,069	-	-	13,915,069
NP Program Reserve	4,145,000	3,359,286	-	-	-	-	-	-	-	-	3,359,286
SUBTOTAL FOR NEIGHBORHOOD PARKS	124,143,127	117,017,140	52,441	86,591	6,566,864	248,480	1,708,220	725,848	1,399,256	-	127,804,840
<u>SPECIAL CITY-WIDE PROGRAMS</u>											
Community Opportunity Fund	5,000,000	5,500,000	-	-	-	-	305,501	4,943,000	-	-	10,748,501
Forestry	4,100,000	4,000,000	-	-	-	-	-	100,000	-	-	4,100,000
Playfields	8,500,000	9,716,154	-	-	-	-	-	-	-	-	9,716,154
Restroom Repair	11,400,000	12,577,000	-	-	-	-	-	-	-	-	12,577,000
Trail	5,000,000	5,000,000	-	-	-	-	-	626,157	-	-	5,626,157
SUBTOTAL FOR SPECIAL CITY-WIDE PROGRAMS	34,000,000	36,793,154	-	-	-	-	305,501	5,669,157	-	-	42,767,812
<u>WATERFRONT PARKS</u>											
Bayfront Park	2,330,367	2,950,000	-	-	-	-	-	-	-	-	2,950,000
Bayview Gateway	3,926,750	3,282,125	-	-	-	-	-	-	-	-	3,282,125
Blue-Greenway Planning & Design Guidelines	325,472	336,000	-	-	-	-	-	-	-	-	336,000
Blue-Greenway Public Art	684,000	684,000	-	-	-	-	-	-	-	-	684,000
Blue-Greenway Signage & Site Furnishings	998,911	989,725	-	-	-	-	-	-	-	-	989,725
Brannan Street Wharf	26,246,271	2,941,050	-	-	-	-	-	4,833,270	-	18,471,951	26,246,271
CEQA Review & Permitting	577,500	577,500	-	-	-	-	-	-	-	-	577,500
Crane Cove Park	21,324,148	1,813,250	-	-	-	-	-	-	-	1,100,000	2,913,250
Heron's Head Park	2,397,861	2,351,000	-	-	-	-	-	-	-	46,861	2,397,861
Pier 43 Bay Trail Link	10,191,508	7,677,800	-	-	-	-	-	90,000	-	2,423,708	10,191,508
Tulare Park	1,029,625	1,130,580	-	-	-	-	-	-	-	-	1,130,580
SUBTOTAL FOR WATERFRONT PARKS	70,032,413	24,733,030	-	-	-	-	-	4,923,270	-	22,042,520	51,698,820
<u>PROGRAM-WIDE SERVICES</u>											
Controller's Audit	185,000	526,245	-	-	-	-	-	-	-	-	526,245
Bond Issuance Cost	2,958,275	584,964	-	-	-	-	-	-	-	-	584,964
SUBTOTAL FOR PROGRAM-WIDE SERVICES	3,143,275	1,111,209	-	-	-	-	-	-	-	-	1,111,209
GRAND TOTAL	231,318,815	179,654,534	52,441	86,591	6,566,864	248,480	2,013,720	11,318,275	1,399,256	22,042,520	223,382,681

**2008 Clean & Safe Neighborhood Park G.O. Bond
Program Budget Reports - Expenditures as of 6/30/14**

Project	Phase	Category	Baseline Budget		Budget		FAMS			Encumbered		Balance	
			All Sources	2008 CSP Bond	All Sources	2008 CSP Bond	Reserve 2008 CSP Bond	Expended		All Sources	2008 CSP Bond	2008 CSP Bond	
								All Sources	2008 CSP Bond				
Neighborhood Parks													
Cabrillo Playground Renovation	CLOSED OUT	Soft Costs	1,017,428	1,017,428									
		Construction Costs	3,083,116	3,083,116									
		Project Contingency	399,456	399,456									
		SUBTOTAL	4,500,000	4,500,000	4,546,591	4,500,000	-	4,498,830	4,466,093	8,740	8,740	25,166	
Cayuga Playground Renovation	CLOSED OUT	Soft Costs	2,115,591	1,653,837									
		Construction Costs	6,410,882	5,011,626									
		Project Contingency	172,783	634,537									
		SUBTOTAL	8,699,256	7,300,000	9,410,035	7,300,000	-	9,249,945	7,197,723	127,826	122,035	(19,758)	
Chinese Recreation Center	CLOSED OUT	Soft Costs	3,849,238	-									
		Construction Costs	15,338,812	12,900,620									
		Project Contingency	1,299,380	1,299,380									
		SUBTOTAL	20,487,430	14,200,000	19,403,517	13,124,924	-	19,366,336	13,115,628	4,530	-	9,296	
Fulton Playground Renovation	CLOSED OUT	Soft Costs	1,075,792	1,075,792									
		Construction Costs	3,259,975	3,259,975									
		Project Contingency	284,233	284,233									
		SUBTOTAL	4,620,000	4,620,000	4,935,000	4,935,000	-	4,916,319	4,916,319	13,884	13,884	4,797	
Glen Canyon Park Renovation	CONSTRUCTION	Soft Costs	1,300,827	1,300,827									
		Construction Costs	3,941,899	3,941,899									
		Project Contingency	557,274	557,274									
		SUBTOTAL	5,800,000	5,800,000	6,191,000	6,191,000	-	5,754,982	5,754,982	11,305	11,305	424,712	
Lafayette Park Renovation	CONSTRUCTION	Soft Costs	2,314,257	2,314,257									
		Construction Costs	7,012,900	7,012,900									
		Project Contingency	872,843	872,843									
		SUBTOTAL	10,200,000	10,200,000	10,400,000	10,200,000	-	10,211,891	10,011,891	93,287	93,287	94,822	
McCoppin Square Renovation	CLOSED OUT	Soft Costs	1,202,174	1,202,174									
		Construction Costs	3,642,953	3,642,953									
		Project Contingency	454,873	454,873									
		SUBTOTAL	5,300,000	5,300,000	3,800,000	3,800,000	-	3,567,851	3,567,851	12,782	12,782	219,367	
Mission Dolores Park Renovation	BID/AWARD	Soft Costs	3,021,400	3,021,400									
		Construction Costs	7,857,200	7,857,200									
		Project Contingency	821,400	821,400									
		SUBTOTAL	11,700,000	11,700,000	16,637,175	16,500,000	-	4,285,979	4,239,748	23,728,470	23,688,470	(11,427,219)	
Mission Dolores Park-Helen Diller Playground	CLOSED OUT	Soft Costs	461,441	-									
		Construction Costs	2,530,000	1,650,000									
		Project Contingency	-	-									
		SUBTOTAL	2,991,441	1,650,000	3,550,167	1,589,930	-	3,550,167	1,589,930	-	-	-	
Mission Playground	CLOSED OUT	Soft Costs	1,710,595	1,710,595									
		Construction Costs	5,183,622	5,183,622									
		Project Contingency	605,783	605,783									
		SUBTOTAL	7,500,000	7,500,000	9,357,000	9,317,000	-	9,309,118	9,269,138	23,232	23,232	24,630	
Palega Playground Renovation	CLOSED OUT	Soft Costs	4,826,692	4,826,692									
		Construction Costs	14,626,340	14,626,340									
		Project Contingency	1,746,968	1,746,968									
		SUBTOTAL	21,200,000	21,200,000	18,200,000	18,200,000	-	16,752,468	16,752,468	589,604	589,604	857,929	
Raymond Kimbell Playground Renovation	BID/AWARD	Soft Costs	741,348	741,348									
		Construction Costs	2,246,508	2,246,508									
		Project Contingency	312,144	312,144									
		SUBTOTAL	3,300,000	3,300,000	4,100,000	4,100,000	-	662,244	662,244	2,436,360	2,436,360	1,001,396	
Sunset Playground Renovation	CLOSED OUT	Soft Costs	3,124,135	3,124,135									
		Construction Costs	9,467,077	9,467,077									
		Project Contingency	1,108,788	1,108,788									
		SUBTOTAL	13,700,000	13,700,000	13,915,069	13,900,000	-	13,724,015	13,708,946	4,186	4,186	186,868	
NP CAPITAL RESERVE		Program Contingency	4,145,000	4,145,000	3,359,286	3,359,286	-	-	-	-	-	3,359,286	
NEIGHBORHOOD PARKS		Soft Costs	23,739,519	21,988,485		-		-		-		-	-
		Construction Costs	76,744,084	79,883,836		-		-		-		-	-
		Project Contingency	8,635,924	9,097,679		-		-		-		-	-
		SUBTOTAL	124,143,127	115,115,000	127,804,840	117,017,140	-	105,850,146	95,252,962	27,054,206	27,003,885	(5,238,708)	
Community Opportunity Fund	PLAN/DES/CONST		5,000,000	5,000,000	10,748,501	5,500,000	-	7,152,090	3,189,908	1,857,573	824,309	1,485,783	
Forestry	DESIGN		4,100,000	4,000,000	4,100,000	4,000,000	-	2,557,376	2,457,376	91,427	91,427	1,451,197	
Playfields	PLANNING		8,500,000	8,500,000	9,716,154	9,716,154	-	2,188,509	2,188,509	2,058,999	2,058,999	5,468,646	
Restroom Repair	PLAN/DES/CONST		11,400,000	11,400,000	12,577,000	12,577,000	-	9,701,195	9,701,195	1,745,795	1,745,795	1,130,010	
Trail	PLAN/DES/CONST		5,000,000	5,000,000	5,626,157	5,000,000	-	2,323,182	2,090,768	935,675	654,164	2,255,069	
CITY-WIDE PROGRAMS SUB-TOTAL:				34,000,000	33,900,000	42,767,812	36,793,154	-	23,922,354	19,627,756	6,689,469	5,374,694	11,790,704

**2008 Clean & Safe Neighborhood Park G.O. Bond
Program Budget Reports - Expenditures as of 6/30/14**

Project	Phase	Category	FAMIS									
			Baseline Budget		Budget		Reserve	Expended		Encumbered		Balance
			All Sources	2008 CSP Bond	All Sources	2008 CSP Bond	2008 CSP Bond	All Sources	2008 CSP Bond	All Sources	2008 CSP Bond	2008 CSP Bond
Bayfront Park		Soft Costs	443,150	443,150								
		Construction Costs	1,887,217	1,887,217								
		Project Contingency	619,633	619,633								
		SUBTOTAL	2,950,000	2,950,000	2,950,000	2,950,000	-	2,330,367	2,330,367	-	-	619,633
Bayview Gateway		Soft Costs	463,379	463,379								
		Construction Costs	2,818,746	2,818,746								
		Project Contingency										
		SUBTOTAL	3,282,125	3,282,125	3,282,125	3,282,125	-	347,922	347,922	9,427	9,427	2,924,776
Blue Greenway Planning & Design Guidelines		Soft Costs	336,000	336,000								
		Construction Costs	-	-								
		Project Contingency	-	-								
		SUBTOTAL	336,000	336,000	336,000	336,000	-	325,472	325,472	-	-	10,528
Blue-Greenway Public Art		Soft Costs	100,000	100,000								
		Construction Costs	584,000	584,000								
		Project Contingency	-	-								
		SUBTOTAL	684,000	684,000	684,000	684,000	-	27,057	27,057	143,943	143,943	513,000
Blue-Greenway Signage & Site Furnishings		Soft Costs	175,000	175,000								
		Construction Costs	1,283,000	1,283,000								
		Project Contingency	-	-								
		SUBTOTAL	1,458,000	1,458,000	989,725	989,725	-	485,431	485,431	400,398	400,398	103,896
Brannan Street Wharf Park		Soft Costs	3,299,268									
		Construction Costs	19,587,850	2,941,050								
		Project Contingency	3,359,153	-								
		SUBTOTAL	26,246,271	2,941,050	26,246,271	2,941,050		24,908,683	2,941,050	18,055	-	-
CEQA Review & Permitting		Soft Costs	577,500	577,500								
		Construction Costs	-	-								
		Project Contingency	-	-								
		SUBTOTAL	577,500	577,500	577,500	577,500	-	444,040	444,040	-	-	133,460
Crane Cove Park		Soft Costs	2,913,250	1,813,250								
		Construction Costs	18,410,898	8,210,898								
		Project Contingency	-	-								
		SUBTOTAL	21,324,148	10,024,148	2,913,250	1,813,250	-	604,602	604,602	209,216	209,216	999,432
Heron's Head Park		Soft Costs	151,000	151,000								
		Construction Costs	2,252,949	2,200,000								
		Project Contingency	-	-								
		SUBTOTAL	2,403,949	2,351,000	2,397,861	2,351,000	-	2,397,861	2,351,000	-	-	-
Pier 43 Bay Trail Link		Soft Costs	2,200,000	2,200,000								
		Construction Costs	7,991,508	5,477,800								
		Project Contingency	-	-								
		SUBTOTAL	10,191,508	7,677,800	10,191,508	7,677,800	-	9,921,768	7,587,499	-	-	90,301
Tulare Park		Soft Costs	216,185	216,185								
		Construction Costs	643,815	368,815								
		Project Contingency	-	-								
		SUBTOTAL	860,000	585,000	1,130,580	1,130,580	-	330,567	330,567	-	-	800,013
WATERFRONT PARKS		Soft Costs	10,874,732	6,475,464								
		Construction Costs	55,459,983	25,771,526								
		Project Contingency	3,978,786	619,633								
		SUBTOTAL	70,313,501	32,866,623	51,698,820	24,733,030	-	42,123,770	17,775,007	781,039	762,984	6,195,039
COGOC Audit Costs			185,000	185,000	526,245	526,245	-	568,245	396,008	1,649,866	130,237	0
Bond Issuance Costs			2,958,275	2,933,377	584,964	584,964	-	568,245	583,033	1,649,866	-	1,931
TOTAL PROGRAM:			231,599,903	185,000,000	223,382,681	179,654,534	-	173,032,760	133,634,767	37,824,446	33,271,800	12,748,967