

# 2008 Clean & Safe Neighborhood Parks Bond

## QUARTERLY STATUS REPORT PRESENTED TO THE

Citizens' General Obligation Bond Oversight Committee

**March 2014**



Mission Dolores Park Groundbreaking Ceremony March 1, 2014

### PREPARED BY

Taylor Emerson, Recreation & Parks Department, Analyst, 581-2546, [taylor.emerson@sfgov.org](mailto:taylor.emerson@sfgov.org)  
Nate Cruz, Port of San Francisco, Analyst, 274-0518, [nate.cruz@sfport.com](mailto:nate.cruz@sfport.com)

### PRESENTED BY

Dawn Kamalanathan, Recreation & Parks Department, Director of Planning and Capital Management, 581-2544

[dawn.kamalanathan@sfgov.org](mailto:dawn.kamalanathan@sfgov.org)

Elaine Forbes, Port of San Francisco, Deputy Director of Finance & Administration, 274-0445

[elaine.forbes@sfport.com](mailto:elaine.forbes@sfport.com)



# **2008 Clean & Safe Neighborhood Parks Bond**

Citizens' General Obligation Bond Oversight Committee

**March 2014**

## **TABLE OF CONTENTS**

### **Executive Summary**

- Program Summary ..... 3
- Program Background ..... 5
- Program Budgets and Funding..... 6

**Project Status Summaries ..... 7**

**Program Timeline & Schedule ..... 26**

### **Program Budget**

- Program Revenues ..... 28
- Program Expenditures..... 29

## Program Summary

### OVERVIEW

In February 2008, San Francisco's voters approved the 2008 Clean and Safe Neighborhood Parks General Obligation ("2008 Bond"). The 2008 Bond provided \$150 million in funding to the Recreation and Parks Department and \$35 million to the Port of San Francisco for specific, voter-approved parks and open space recreation projects. Below is a summary of the status of the agencies' progress, followed by additional detail on each project.

### Recreation and Parks Department Projects

As of February 28, 2014, there are ten (10) Neighborhood Park projects complete and Open to the Public: McCoppin Square, Helen Diller Playground at Mission Dolores, Mission Playground, Chinese Recreation Center, Fulton Playground, Sunset Playground, Lafayette Park, Cabrillo Playground, Cayuga Playground, and Palega Playground; two (2) projects in construction: Glen Canyon Park and Mission Dolores Park; and one (1) project in bid/award phase: Raymond Kimbell Playground. The Citywide programs are preceding under their group implementation plans.



### Neighborhood Park highlight:

Following more than 50 community design meetings, extensive environmental review and extensive regulatory oversight, the Mission Dolores Park Groundbreaking Ceremony was on March 1, 2014. The construction will be phased, beginning with the northern half now in Construction. With an approved budget of \$16.4 million, this project includes renovated tennis and basketball courts, a new multi-use court, improved access, dog play areas, irrigation, bike racks, and a new outlook in the southeast corner. The first phase is scheduled for completion in fall 2014. The southern portion of phase 2 will begin after the northern portion re-opens.

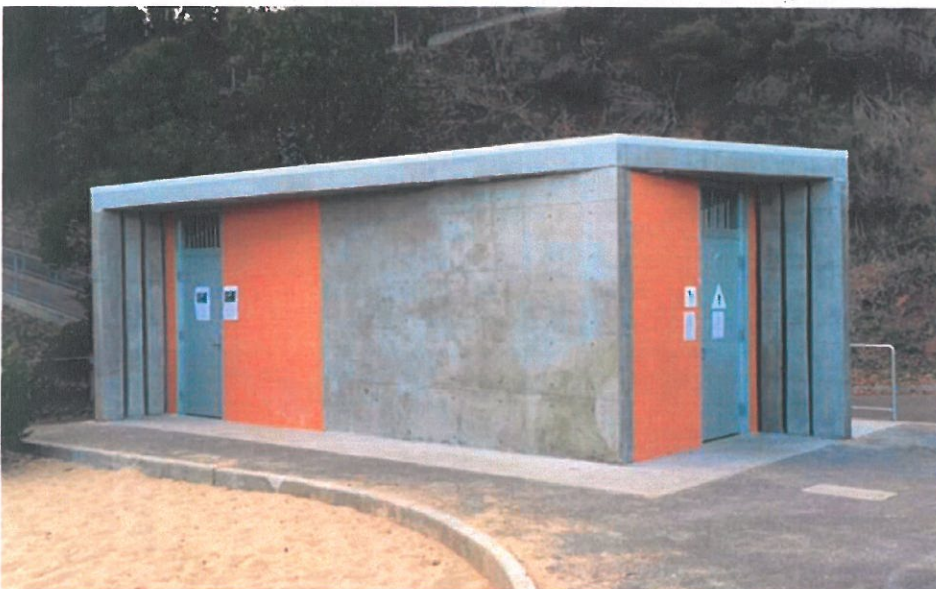

**Citywide Program highlights:** The Restroom Renovation and Replacement program is progressing. To date, 13 restrooms are complete and Open to the Public, one (1) is in construction, two (2) more are in bid/award, one (1) is in design, and two (2) are in planning. These restrooms are designed for enhanced durability, security, and ease of maintenance. Approximately 86% of the Restroom program funds are spent and encumbered.

## Program Summary

### Waterfront Parks highlights:

The Port received authority to issue \$33.5 million dollars to be expended on projects to improve waterfront open spaces. Highlights of these Port projects are described below.

- As of January 31, 2014, five of the 10 Port projects are substantially complete, including Pier 43 Bay Trail Link, Bayfront Park, Heron's Head Park, and Brannan Street Wharf projects, and the Blue Greenway Planning & Design Guidelines.
- The Board of Supervisors is considering a supplemental reappropriation (File 14-0188) of \$1.1 million in 2008 GO Bonds to reallocate funds from three projects with savings to three projects with estimated funding shortfalls, as shown below:

Project Name	Project Status	Current Budget	Expiring Grant Funds	Other Port Capital Funds	Proposed Reappropriation	Proposed New Budget
<b>Sources</b>						
Blue Greenway Signage and Site Furnishings	In Construction	\$ 1,458,000			\$ (459,089)	\$ 998,911
Blue Greenway Planning and Design	Completed	\$ 336,000			\$ (10,528)	\$ 325,472
Bayfront Park	Completed	\$ 2,950,000			\$ (619,633)	\$ 2,330,367
<b>Total Sources</b>					<b>\$ (1,089,250)</b>	
<b>Uses</b>						
Bayview Gateway Park	Preparing to go out to bid	\$ 3,282,125			\$ 644,625	\$ 3,926,750
Tulare Park	Preparing to go out to bid	\$ 860,000	\$ (275,000)	\$ 175,000	\$ 444,625	\$ 1,204,625
<b>Total Uses</b>					<b>\$ 1,089,250</b>	

The supplemental appropriation has been approved by the Port Commission and the Capital Planning Committee. However, because the appropriation is pending Board of Supervisors approval, the budgets shown in this report do NOT include the impact of the proposed appropriation.

- As a cost savings measure, the Bayview Gateway and Tulare Park projects will be constructed under a single contract. These two projects are located across Islais Creek from one another, therefore efficiencies from combined mobilization and work should be realized by the Port.
- The SF Arts Commission released a call for artist to submit qualifications for the project in the fall of 2014 and expects to select 3 artists to submit proposals. The final artist will be selected in the summer of 2014 with fabrication and installation to occur in late 2014.

### Future Bond Sale Plans:

- The third bond sale was successfully completed in February 2012 and proceeds were appropriated. This was the third and final sale for Recreation and Parks and will fund all remaining design and construction. The fourth and final bond sale for the Port of San Francisco's waterfront park projects is anticipated for late 2014.

### Program Background

- The Port of San Francisco's Waterfront Parks program includes community planning efforts for the Blue Greenway and constituent parks, as well as new open space projects in the Northern Central Waterfronts. The program will add or improve seven open spaces and total \$33.5 million.

## Program Summary

### Program Background

- In February of 2008 the citizens of San Francisco passed Proposition A, a \$185 Million General Obligation Bond, known as the 2008 Clean and Safe Neighborhood Parks Bond.
- The \$185 million in bond funding is divided into two allocations based on the jurisdiction of the parks and facilities scheduled to receive funding, with \$151.3 million committed to the Recreation and Parks Department and \$33.5M dedicated to the San Francisco Port. \$185,000 is set aside in a Citizen's Oversight Audit fund.
- The objectives of this bond program are as follows: 1) Fix and improve park restrooms citywide; 2) Eliminate serious earthquake safety risks in neighborhood and waterfront park facilities; 3) Renovate parks and playgrounds in poor physical condition; 4) Replace dilapidated playfields; 5) Repair nature trail systems in the city's parks; and 6) Attract matching community and philanthropic support.
- The Recreation and Parks Department's 2008 Clean and Safe Neighborhood Parks Bond Program is divided into six sub-programs. The bulk of funding (80%) is dedicated to funding Major Capital Renovations at 12 Neighborhood Parks. The remaining funds (20%) are divided between five City- Wide programs.
  - Major capital renovation of Neighborhood Parks. The bond program allocates the majority of its funds to capital improvements at Neighborhood Parks across the city. These parks were selected based on the extent to which they are unsafe in an earthquake, in poor physical condition, as well as their ability to provide basic, recreational uses to many San Franciscans.
  - Restroom Repair and Replacement Program. Many of the city's park restrooms are in a state of severe dilapidation; some bathrooms require replacement, others require repairs, and some parks need restrooms. The \$11.4 million will fund a restroom replacement, repair, and installation program. Sites will be chosen in coordination with the community, through an open process guided by the Recreation and Parks Department Commission.
  - Park Playfield Repairs and Reconstruction. The City's playfields have been "loved to death"- overused due to a citywide shortage of soccer, baseball and multi-use fields. With the growing demand of field athletics, it is difficult to meet demand while keeping the fields at an acceptable playing condition. Over the past five years, a successful public/private partnership between the Recreation and Parks Department and the City Fields Foundation has resulted in the renovation of playfields at 6 park facilities with a current philanthropic contribution of over \$14 M. Each field has become some of the most requested play fields by park users. These renovated fields are improved by the installation of synthetic turf and night lighting which increased play time by more than 31,000 hours, while reducing maintenance needs and water demand. This \$8.5 million will continue that partnership.
  - Park Forestry Needs. Over 100,000 trees populate the city's parks and open spaces. These funds will provide for an assessment of the health and condition of this urban forest, as well as provide resources to enact the recommendations of the assessment and plant new trees.
  - Park Trail Reconstruction. The 2004 Recreation Assessment identified walking and biking trails as the #1 most needed recreational amenity; residents also cited hiking and visiting nature as the two activities in which they would like to participate in more often. The Park Trail Reconstruction program will restore trails and make capital improvements that allow residents to enjoy and experience nature in the parks.
  - Community Opportunity Fund (formerly Community Opportunity Grants Program). The Community Opportunity Fund Program is a capital program that allows residents, neighborhood groups and park advocates to initiate improvements in their parks by matching community-nominated capital projects with other private gifts and grants.

### Program Background

- The Port of San Francisco's Waterfront Parks program includes community planning efforts for the Blue Greenway and constituent parks, as well as new open space projects in the Northern Central Waterfronts. The program will add or improve seven open spaces and total \$33.5 million.

## Program Summary

### Program Budgets and Funding

- Budgets

#### Recreation and Parks Department:

Major Capital Program	
Chinese Recreation Center	14.2
Mission Playground	7.5
Palega Recreation Center	21.2
Cayuga Playground	7.3
McCoppin Square	5.3
Sunset Playground	13.7
Fulton Playground	4.2
Mission Dolores Park	13.2
Cabrillo Playground	4.5
Glen Canyon Park	5.8
Lafayette Park	10.2
Raymond Kimbell Playground	3.3
NP Contingency Funds	4.7

**Major NP Projects Program \$115.1M**

Citywide Programs	
Restroom Repair Program	11.4
Park Playfields Program	8.5
Park Forestry Program	4.0
Park Trail Program	5.0
Community Opportunity Fund	5.0

**Other Citywide Programs \$33.9M**

**Bond Issuance Costs<sup>1</sup> \$2.3**

**RPD Bond Program Total \$151.3M**

#### Port of San Francisco:

Major Capital Program	
Pier 43 Bay Trail Link	7.7
Brannan Street Wharf	2.9
Blue-Greenway Improvement	21.4
Blue-Greenway DS Standard	.2
CEQA Review & Permitting	.6
WP Bond Issuance Cost	.7

**Major WP Projects Program \$33.5M**

CGOBOC Audit Costs .2

**TOTAL Bond Program \$185.0M**

### Funding

Based on the adopted project budgets and schedules, a plan has been developed to break funding into three sales. The strategy for sales is as follows:

- Sale 1 was completed in August 2008 to fund planning and design for the first 7 of 12 Major Capital projects (Phase I)<sup>2</sup>, Citywide Programs, and Waterfront Parks.
- Sale 2 was completed in early April 2010. Funds from this sale are intended for the construction of Phase I projects, Waterfront Parks, and Citywide Programs; and planning and design of the remaining five Major Capital projects (Phase II)<sup>2</sup>, Citywide Programs, and Waterfront Parks.
- Sale 3 funded construction of Waterfront Parks, and all remaining RecPark projects.
- Sale 4 will fund all Waterfront Park projects.
- The sale forecast developed for the projects managed by the Recreation and Parks Department and the San Francisco Port is as follows:

Sale	Date	Amount
1st Sale	8/2008	\$ 42,520,000
2nd Sale	4/2010	\$ 60,430,000
3rd Sale	2/2012	\$ 73,355,000
4 <sup>th</sup> Sale	TBD	\$ 8,715,000
<b>TOTAL</b>		<b>\$185,000,000</b>

Distribution of the sale revenue between the agencies, and those budgeted for other bond related costs is outlined below. Other costs include the cost of bond issuance, bond oversight and program auditing.

Sale	SFRPD	SF Port	Other
1st Sale	\$38,457,502	\$3,644,438	\$418,060
2nd Sale	\$49,415,317	\$10,616,312	\$398,371
3rd Sale*	\$62,300,484	\$10,415,765	\$638,751
4 <sup>th</sup> Sale*	\$0	\$ 8,465,000	\$250,000

\* Other costs to be determined, therefore distribution is only conceptual.

## Project Status Summaries

- Major Neighborhood Park Phase I Projects:**

### Chinese Recreation Center

**Project Location:** 1101 Washington Street

**Project Manager:** Toks Ajike,  
[toks.ajike@sfgov.org](mailto:toks.ajike@sfgov.org); (415) 581-2543

**Project Description:** Work at the Chinese Recreation Center included full replacement of the recreation center; repairs and renovation of the court and children's play area; restoration of existing pathways; upgrades to site infrastructure; improvements to accessibility and overall reconditioning of the park landscape. Construction is complete and this project was **Open to the Public in July 2012**.

#### **Project Schedule:**

	Start	Finish
Baseline/Original	Pre-2008	Sep 2010
Actual	Jun 2008	July 2012

#### **Project Budget**

Original Budget	\$20,704,394
Current Budget	\$20,704,394
Current Projected	\$20,487,430
Actual Expenditures	\$19,363,151



### Mission Playground

**Project Location:** 19<sup>th</sup> and Linda Street

**Project Manager:** Meghan Tiernan;  
[meghan.tiernan@sfgov.org](mailto:meghan.tiernan@sfgov.org); (415) 581-2557

**Project Description:** The Mission Playground scope included renovated athletic courts; seismic upgrades to the clubhouse; renovated pathways; improvements to the swimming pool filter, site irrigation, and lighting; removal of ADA accessibility barriers; addition of shading devices and overall reconditioning of the park landscape. Additionally, through the generosity of the City Fields Foundation, the Mission Playground has a new synthetic soccer field. The original scope is complete and was Open to the Public September 15, 2012. A second phase, including repair to the pool building and systems, is now complete and was **Open to the Public in August 2013**.

#### **Project Schedule**

	Start	Finish
Baseline/Original	Aug 2008	May 2011
Actual	Mar 2009	Aug 2013

#### **Project Budget**

Original Budget	\$7,500,000
Current Budget	\$9,357,000
Current Projected	\$9,357,000
Actual Expenditures	\$9,034,203



## Project Status Summaries

### Palega Playground

**Project Location:** 500 Felton Street

**Project Manager:** Toks Ajike

[toks.ajike@sfgov.org](mailto:toks.ajike@sfgov.org); (415) 581-2543

**Project Description:** Renovation of the Palega Playground included repair and/or renovation of the recreation center, fields, courts, and children's play area; improvements to the pathway network; upgrades to the irrigation and lighting systems; modifications to the site to remove barriers and improve accessibility, and overall reconditioning of the park landscape. Project scope also included a building addition to meet the growing demands for indoor recreational space. The project is complete and was **Open to the Public in November 2013**.

#### **Project Schedule**

	Start	Finish
Baseline/Original	Aug 2008	May 2012
Actual	Jul 2009	October 2013

#### **Project Budget**

Original Budget	\$21,200,000
Current Budget	\$18,200,000
Current Projected	\$18,200,000
Actual Expenditures	\$16,651,886



### Cayuga Playground

**Project Location:** 1898 Cayuga Street

**Project Manager:** Marvin Yee;

[marvin.yee@sfgov.org](mailto:marvin.yee@sfgov.org); (415) 581-2541

**Project Description:** The project scope includes site reconfiguration; a new clubhouse, playground, and courts; and field renovation. Unique wooden sculptures found throughout the park have been inventoried and catalogued. BART is contributing \$1.355 million, which is the value to restore park features that will be impacted during BART's Emergency Safety Program (ESP) work in Cayuga Park. This project is complete and **Open to the Public in August 2013**.

#### **Project Schedule**

	Start	Finish
Baseline/Original	Aug 2008	May 2011
Actual	Feb 2009	July 2013

#### **Project Budget**

Original Budget	\$7,300,000
Current Budget	\$9,410,035
Current Projected	\$9,410,035
Actual Expenditures	\$9,247,605



## Project Status Summaries

### McCoppin Square

**Project Location:** 24<sup>th</sup> Avenue and Taraval Street

**Project Manager:** Meghan Tiernan;

[meghan.tiernan@sfgov.org](mailto:meghan.tiernan@sfgov.org); (415) 581-2557

**Project Description:** The project scope included relocation of children's play area, installation of new play equipment, renovation of athletic fields and tennis court; restoration of existing roads and pathways; upgrades to the irrigation and lighting systems; site modifications to remove barriers and improve ADA accessibility, overall reconditioning of the park landscape, and installation of a new restroom building. The project started construction in October 2010 and was **Open to the Public in October 2011**.



#### **Project Schedule**

	Start	Finish
Baseline/Original	Oct 2008	Jul 2011
Actual	Jan 2009	Oct 2011

#### **Project Budget**

Original Budget	\$5,300,000
Current Budget	\$3,800,000
Current Projected	\$3,800,000
Actual Expenditures	\$3,558,925

### Sunset Playground

**Project Location:** 2201 Lawton Street

**Project Manager:** Dan Mauer;

[dan.mauer@sfgov.org](mailto:dan.mauer@sfgov.org); (415) 581-2542

**Project Description:** The project scope included the repair and renovation of the recreation center/ gymnasium, children's play area, fields, and courts; restoration of existing pathways; upgrades to the irrigation and lighting systems; modifications to the site to remove barriers and improve accessibility, and overall reconditioning of the park landscape. Construction started in June 2011 and the renovated field opened on March 1, 2012. Remainder of the project is complete and was **Open to the Public in November 2012**.

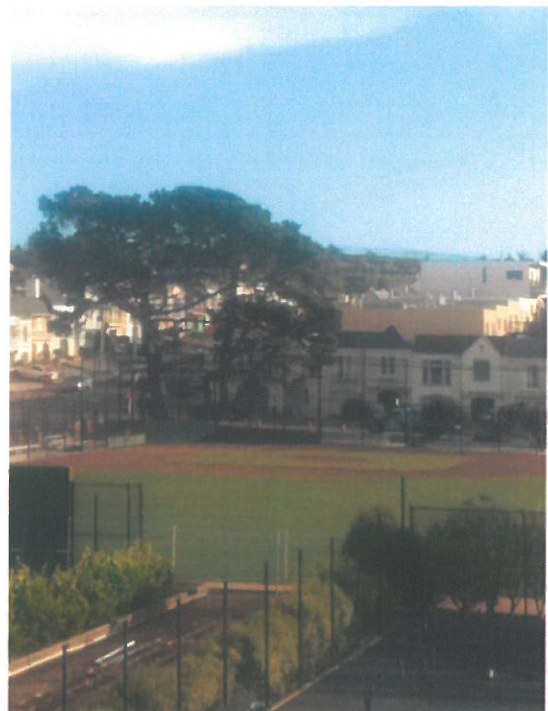

#### **Project Schedule**

	Start	Finish
Baseline/Original	Aug 2008	Jan 2012
Actual	Feb 2009	Nov 2012

#### **Project Budget**

Original Budget	\$13,700,000
Current Budget	\$13,700,000
Current Projected	\$13,700,000
Actual Expenditures	\$13,708,998

## Project Status Summaries

### Fulton Playground

**Project Location:** 855 27<sup>th</sup> Avenue

**Project Manager:** Pauline Araica;

[pauline.araica@sfgov.org](mailto:pauline.araica@sfgov.org); (415) 581-2558

**Project Description:** Fulton Playground project included the rehabilitation of the clubhouse (which has been designated a historical resource by the Planning Department), renovation of the children's play areas and sport courts, and site improvements. The project is complete and was **Open to the Public in October 2012**.

#### **Project Schedule**

	Start	Finish
Baseline/Original	Aug 2008	Jan 2011
Actual	Feb 2009	Oct 2012

#### **Project Budget**

Original Budget	\$4,200,000
Current Budget	\$4,935,000
Current Projected	\$4,935,000
Actual Expenditures	\$4,914,820



### Mission Dolores Park – Helen Diller Playground

**Project Location:** Dolores Street and 19<sup>th</sup> Avenue

**Project Manager:** Mary Hobson;

[mary.hobson@sfgov.org](mailto:mary.hobson@sfgov.org); (415) 581-2575

**Project Description:** The Recreation and Parks Department collaborated with the Friends of Dolores Park Playground and the Urban Resource Systems, Inc. in the total renovation of the play area. Additionally, RPD partnered with the Mercer Foundation and Friends of Dolores Park Playground for a generous donation of \$1.5 million to fund the project. The playground is complete and was **Open to the Public in March 2012**.

#### **Project Schedule**

	Start	Finish
Baseline/Original	Dec 2007	Apr 2010
Actual	Jan 2008	Mar 2012

#### **Project Budget**

Original Budget	\$3,250,000
Current Budget	\$3,647,885
Current Projected	\$3,647,885
Actual Expenditures	\$3,550,167



## Project Status Summaries

### Mission Dolores Park Renovation

**Project Location:** Dolores Street and 19<sup>th</sup> Avenue

**Project Manager:** Jake Gilchrist;

[jacob.gilchrist@sfgov.org](mailto:jacob.gilchrist@sfgov.org); (415) 581-2561

**Project Description:** Currently in the Construction phase on the northern half of the site, called Phase 1, the full project scope includes the replacement and/or renovation of the clubhouse, restrooms, picnic area, sport courts, pathways, irrigation, drainage, lighting, and landscape planting. The project will be constructed and delivered in two phases, with the first scheduled to be complete in Fall 2014 and the second in Summer 2015.



#### **Project Schedule**

	Start	Finish
Baseline/Original	Oct 2009	Mar 2013
Actual	May 2010	June 2015

#### **Project Budget**

Original Budget	\$11,700,000
Current Budget	\$16,597,175
Current Projected	\$16,597,175
Actual Expenditures	\$2,656,424

### Cabrillo Playground

**Project Location:** 855 27<sup>th</sup> Avenue

**Project Manager:** Pauline Araica;

[pauline.araica@sfgov.org](mailto:pauline.araica@sfgov.org); (415) 581-2558

**Project Description:** Cabrillo Playground project includes the repair and/or renovation of the clubhouse, children's play area, picnic areas, sport courts, upgrades to infrastructure, accessibility improvements, and overall reconditioning of the park landscape. The project is complete and was **Open to the Public in August 2013**.



#### **Project Schedule**

	Start	Finish
Baseline/Original	Oct 2009	Aug 2012
Actual	Jun 2010	August 2013

#### **Project Budget**

Original Budget	\$4,500,000
Current Budget	\$4,500,000
Current Projected	\$4,500,000
Actual Expenditures	\$4,475,922

## Project Status Summaries

### Glen Canyon Park

**Project Location:** Elk Street and O'Shaughnessy Blvd.

**Project Manager:** Karen Mauney-Brodek;

[karen.mauney-brodek@sfgov.org](mailto:karen.mauney-brodek@sfgov.org); (415) 575-5601

**Project Description:** RPD partnered with the Trust for Public Land to host a series of six community improvement workshops in order to determine the project to be funded by the 2008 Clean and Safe Neighborhood Parks Bond. After this extensive community outreach process, the project scope will include the following areas: a larger welcoming entry with a vehicular drop-off on Elk Street, a pedestrian path and landscaping, a new expanded children's playground, and new tennis courts. Additionally, there will be minor repairs to the Recreation Center and an exteriorly accessible restroom will be provided to comply with the Americans with Disabilities Act. This project is substantially complete and will be **Open to the Public March 15, 2014**.



#### **Project Schedule**

	Start	Finish
Baseline/Original	Oct 2009	Jan 2013
Actual	May 2010	March 2014

#### **Project Budget**

Original Budget	\$5,800,000
Current Budget	\$5,800,000
Current Projected	\$5,800,000
Actual Expenditures	\$5,523,519

### Lafayette Park

**Project Location:** Gough Street at Washington Street

**Project Manager:** Mary Hobson

[mary.hobson@sfgov.org](mailto:mary.hobson@sfgov.org); (415) 581-2575

**Project Description:** The project scope will include the renovation the children's play area, restroom, picnic area, and courts; restoration of roads and pathways; upgrades to the infrastructure including lighting and irrigation, modifications to the site to remove barriers and improve accessibility, and overall reconditioning of the park landscape. The project is complete and was **Open to the Public in June 2013**.



#### **Project Schedule**

	Start	Finish
Baseline/Original	Dec 2009	May 2013
Actual	Jun 2010	June 2013

#### **Project Budget**

Original Budget	\$10,200,000
Current Budget	\$10,200,000
Current Projected	\$10,200,000
Actual Expenditures	\$10,073,439

## Project Status Summaries

### Raymond Kimbell Playground

**Project Location:** Geary Blvd. and Steiner Street

**Project Manager:** Dan Mauer

[dan.mauer@sfgov.org](mailto:dan.mauer@sfgov.org); (415) 581-2542

**Project Description:** The project scope will include the replacement of restroom and locker room facilities, the children's play area, and lawns; restoration of pathways; upgrades to the infrastructure including lighting and irrigation, modifications to the site to remove barriers and improve accessibility, and overall reconditioning of the park landscape. The athletic fields were renovated in partnership with the City Fields Foundation and opened in June 2010.



### **Project Schedule**

	Start	Finish
Baseline/Original	Feb 2010	Nov 2012
Actual	Jul 2010	June 2015

### **Project Budget**

Original Budget	\$3,300,000
Current Budget	\$4,100,000
Current Projected	\$4,100,000
Actual Expenditures	\$635,463

## • Citywide Programs

### Restroom Repair And Replacement Program

**Project Manager:** Marvin Yee

[marvin.yee@sfgov.org](mailto:marvin.yee@sfgov.org); (415) 581-2541

The Restroom Repair and Replacement program funds the construction, repair, and renovation of restroom facilities. Many of the city park's restrooms are old, need repair, and are poorly designed for maintenance and proper supervision. Per the 2008 Bond Report, the Recreation & Parks Commission has appointed a Restroom Taskforce to work with staff and the community to develop recommendations for which restrooms should be renovated, replaced or added. The Restroom Taskforce developed a plan to renovate or replace 18-21 restrooms, depending on costs. To date, 13 restrooms are complete and Open to the Public, one is in construction, one in bid/award, and four in planning or design.



## Project Status Summaries

### **Park Playfields Repair And Reconstruction Program**

**Project Manager:** Dan Mauer

[dan.mauer@sfgov.org](mailto:dan.mauer@sfgov.org); (415) 581-2542

The Playfields Initiative is a public-private partnership between the City Fields Foundation and the Recreation and Parks Department. The goal of the program is to address the chronic shortage of athletic fields in San Francisco and equitably provide sports facilities for youth and adult leagues, school teams, physical education classes and informal neighborhood play. To date, the program has renovated 6 parks increasing the overall play hours by 31,000 hours. (62,000 overall hours with reorganization to our field permits system)

Using a new generation of synthetic turf, select athletic fields across the City have been completely overhauled with field drainage, goals and backstops/fencing, bleachers, garbage cans, signage, and field lights.

The 2008 Clean and Safe Neighborhood Parks Bond will provide \$8.5 million in funding which will be coupled with private dollars to renovate the four athletic fields at the Beach Chalet in Golden Gate Park, as well as the athletics fields at Minnie Lovie Recreation Center. The overall philanthropic funding match for this program is 1 to 1 with a current expended gift of over \$14 M to date.



### **Park Forestry Program**

**Project Manager:** Steven Korovesis

[steven.korovesis@sfgov.org](mailto:steven.korovesis@sfgov.org); (415) 581-2547

The Recreation & Park Department's forest is estimated to contain roughly 131,000 trees. It has not received major physical attention since the original planting. Though one of the most important elements of our urban parks is the trees, the first a thorough assessment and plan for the care, repair and planting of new trees was funded in the 2008 Bond..

Under this program, the Recreation and Park Department engaged forestry professionals to identify sites that pose the greatest potential of tree failure. Using data for facility usage and tree failure history, the forestry team created a prioritized list for all RPD facilities that was reviewed and approved by the Recreation and Parks Commission in February 2010. The bond program will initially address the highest priority sites. The scope includes assessing trees with accepted urban forestry techniques such as the hazard rating system, and packaging tree pruning and removal work into contracts for public bid.



## Project Status Summaries

### **Park Trail Reconstruction Program**

**Project Manager:** Melinda Stockmann

[melinda.stockmann@sfgov.org](mailto:melinda.stockmann@sfgov.org); (415) 581-2548

Nature trails in San Francisco's parks are in poor shape – frequently in need of erosion control and other improvements to the condition of the surrounding landscape. 2008 Clean and Safe NP Bond funds will improve access and opportunities to walk and hike, allowing residents to better enjoy and experience nature and vistas in San Francisco parks.

In order to prioritize projects, staff worked with Recreation and Parks Department Commission, PROSAC, and other stakeholders to develop objective criteria to develop a prioritized list of parks for improvement. Criteria focused on three areas equally 1) Access, 2) Conservation and 3) Safety. The prioritization developed focuses on improvements at 10 sites to receive capital work through this bond. The list of sites for the Bond's Trails Program was presented to and approved by the RPD Commission on June 4<sup>th</sup>, 2009. With this approval, project staff began to focus on the specific design and community process for each trail site.



**Figure 1: Grandview Trail, completed early 2012**

### **Community Opportunity Fund Program**

**Project Manager:** Jake Gilchrist

[jacob.gilchrist@sfgov.org](mailto:jacob.gilchrist@sfgov.org); (415) 581-2561

The Community Opportunity Fund Program provides neighborhoods, community groups and people who love and care for their parks an opportunity to receive improvements for a Recreation & Parks Department park they nominate. The program promotes increased stewardship of parks by encouraging volunteer and fundraising partnerships. The program is separated into 3 application and award rounds. Round 1 of the Community Opportunity Fund began in late June 2010, Round 2 in March 2011, and Round 3 March 2012. All COF awards have now been completed, and new applicants are directed to the 2012 Bond COF Program. Round 4 applications are due in April 2014.



**Community Opportunity Fund Program**

## Project Schedules

### Major Waterfront Park Projects

#### **Pier 43 Bay Trail Link: *SUBSTANTIALLY COMPLETE***

**Project Location:** Powell to Taylor Streets – Embarcadero

**Project Manager:** Steven Reel, [steven.reel@sfpport.org](mailto:steven.reel@sfpport.org); (415) 274-0574

Located along the Bay north of the Pier 43 Arch, the site previously consisted of condemned piers and partially closed sidewalk due to a failing seawall. The project created a new waterfront open space destination featuring a public promenade along the water's edge. The project removed 70,000 SF of pier, replaced 520 linear feet of seawall, constructed 20,600 SF of pile supported concrete wharf, and reconstructed sidewalks, curbs and gutters.

During the entitlement process, scope was added to the project for additional wharf area (requested by the Bay Conservation and Development Commission, or BCDC), for ADA improvements near Pier 45, and for security lighting. The additional scope caused a delay of 1 month and increased the estimated cost by \$2 M. To fund the additional scope, Port used capital funds and grants from the Association of Bay Area Governments (ABAG) and the Federal Department of Homeland Security (DHS).

This Project is complete and open to the public.



Budget	GO Bond	Total Funds
Original Budget	\$7,677,800	\$7,808,263
Current Approved Budget	\$7,677,800	\$10,191,508
Actual Expenditures To Date	\$7,583,053	\$9,917,322

Schedule	Original	Current Forecast or Actual
Planning	March 2008	July 2008
Design	November 2009	December 2009
Construction	January 2011	July 2011
Completion	June 2012	November 2012

## Project Schedules

### **Brannan Street Wharf: SUBSTANTIALLY COMPLETE**

**Project Location:** Embarcadero at Brannan Street

**Project Manager:** Steven Reel, [steven.reel@sfpport.org](mailto:steven.reel@sfpport.org); (415) 274-0574

Located along the Bay in the South Beach neighborhood, the project created a 57,000 SF public open space wharf along approximately 850 linear feet of waterfront which was previously inaccessible due to condemned wharf and pier structures. Features, as recommended by a citizen's advisory committee, include a raised lawn, public float, seating, and interpretive exhibits.

Preliminary engineering studies indicated the need for unexpected repairs and strengthening of a portion of the existing seawall; revealed deteriorated structure supporting a portion of The Embarcadero Promenade; uncovered ground instability within the new wharf area; and identified complexity in the removal of the existing Pier 36 caissons. Recognizing a funding shortfall, the Port was successful in obtaining \$4.7M of federal funds specifically for pier removal. The funding required pier removal to be delivered as a separate project lead by the US Army Corps of Engineers and triggered additional environmental review (NEPA) resulting in a 1 year schedule delay.

Even with the additional funding, the public float had to be excluded from the project to resolve the budget deficit.

Construction of the wharf commenced in December 2011. The wharf is substantially complete and open to the public.



Budget	GO Bond	Total Funds
Original Budget	\$2,941,050	\$20,544,030
Current Approved Budget	\$2,941,050	\$26,246,271
Actual Expenditures To Date	\$2,941,050	\$24,739,505

Schedule	Original	Current Forecast or Actual
Planning	January 2008	July 2008
Design	July 2009	October 2009
Construction	September 2010	December 2011
Completion	August 2012	July 2013

## Project Schedules

### **Blue Greenway Planning & Design Guidelines: SUBSTANTIALLY COMPLETE**

**Project Location:** The Southern Waterfront, running from Mission Creek to Pier 98

**Project Manager:** David Beaupre, [david.beaupre@sfpport.org](mailto:david.beaupre@sfpport.org); (415) 274-0539

The Blue-Greenway Design standards evolved through the community planning process to be more than just design guidelines. Stakeholders, the Port Commission and City agency partners agreed that to be more useful, the process and results required more planning to understand the opportunities along the entire Blue Greenway. However, as the scope was refined, it was determined that it would be difficult to develop design standards without a better understanding of the entire scope of potential projects within the Blue-Greenway. Therefore the planning process was expanded to include the identification of open space opportunities, identification of programming (uses) options, project cost estimates and the development of an implementation strategy to improve the Blue Greenway, including project prioritization.

The Port hosted a series of community meetings and the guidelines were substantially complete in September of 2013.

*This project budget is subject to change under a pending supplemental appropriation, currently before the Board of Supervisors. The approved budget shown below will be updated after the appropriate approvals have been granted.*



Budget	GO Bond	Total Funds
Original Budget*	\$2,533,250	\$2,533,250
Current Approved Budget	\$336,000	\$336,000
Actual Expenditures To Date	\$325,472	\$325,472

Schedule	Original	Current Forecast or Actual
Planning	March 2008	May 2008
Design	N/A	N/A
Construction	N/A	N/A
Completion	August 2009	September 2013

\* The original budget for this project included funding for signage and site furnishings; however, these elements have since been separated into a new project called "Blue Greenway Signage and Site Furnishings" with a distinct budget and schedule.

## Project Schedules

### **Bayfront Park: SUBSTANTIALLY COMPLETE**

**Project Location:** Terry A. Francois Street, between South Street and Mariposa

**Project Manager:** David Beaupre, [david.beaupre@sfport.org](mailto:david.beaupre@sfport.org); (415) 274-0539

This project along the Blue Greenway included the removal of deteriorated piers and wharves, and reconstruction of 1,200 linear feet of shoreline to allow Bayfront Park to be constructed to the Bay's edge. The shoreline project included the installation of a temporary 8' wide mixed use pathway to allow the public to access the shoreline while the Park was under construction. This project is complete and opened to the public in February of 2012.

*This project budget is subject to change under a pending supplemental appropriation, currently before the Board of Supervisors. The approved budget shown below will be updated after the appropriate approvals have been granted.*



Budget	GO Bond	Total Funds
Original Budget	\$2,950,000	\$2,950,000
Current Approved Budget	\$2,950,000	\$2,950,000
Actual Expenditures To Date	\$2,330,367	\$2,330,367

Schedule	Original	Current Forecast or Actual
Planning	January 2008	January 2008
Design	January 2009	January 2009
Construction	March 2010	September 2011
Completion	February 2011	February 2012

## Project Schedules

### **Heron's Head Park: SUBSTANTIALLY COMPLETE**

**Project Location:** Jennings Street and Cargo Way

**Project Manager:** David Beaupre, [david.beaupre@sfpport.org](mailto:david.beaupre@sfpport.org); (415) 274-0539

This Blue Greenway project included an expansion of the existing Heron's Head Park by approximately an acre, by: a) converting a paved area into a meadow, and planter areas; b) organizing the service and parking areas; c) creating a dog run; d) installing picnic tables and seating areas, new lighting and bicycle amenities; e) adding park signage; f) including new sites for public art; g) creating a defined pedestrian circulation area; and h) adding a landscape based storm-water treatment system. The design is consistent with the sustainable natural theme of the existing park.

The original budget established was based upon a smaller park opportunity site, in preparing the design and working through the community review process the project site was enlarged. The GO Bond funding strategy for Blue Greenway Parks accommodated opportunity for projects to expand or consolidate through the planning process. This project was completed and opened to the public in September 2012.



Budget	GO Bond	Total Funds
Original Budget	\$550,000	\$550,000
Current Approved Budget	\$2,351,000	\$2,403,949
Actual Expenditures To Date	\$2,351,000	\$2,403,949

Schedule	Original	Current Forecast or Actual
Planning	January 2009	January 2009
Design	October 2009	March 2010
Construction	December 2010	December 2011
Completion	May 2011	September 2012

## Project Schedules

### Tulare Park

**Project Location:** Islais Creek shoreline, north side between Illinois and Third Streets

**Project Manager:** David Beaupre, [david.beaupre@sfpport.org](mailto:david.beaupre@sfpport.org); (415) 274-0539

Across Islais Creek from the future site of the Bayview Gateway, Tulare Park is an existing Blue Greenway Park that was originally constructed in the early 1970s and is in need of major improvements including upgrades required under the Americans with Disabilities Act (ADA). During final design of the Tulare Park improvements, it was determined that grading required to create the ADA accessible path would pose significant risk of damage to both the San Francisco Public Utilities Commission force main and the existing retaining wall running throughout the site. After studying alternatives, a pedestrian bridge was chosen as the most cost effective solution to create an accessible pathway. With design complete, the total project cost is now estimated at \$1.2 M, approximately 33% (\$0.3M) above the original budgeted amount of \$0.9M.

***This project budget is subject to change under a pending supplemental appropriation, currently before the Board of Supervisors. The approved budget shown below will be updated after the appropriate approvals have been granted.***

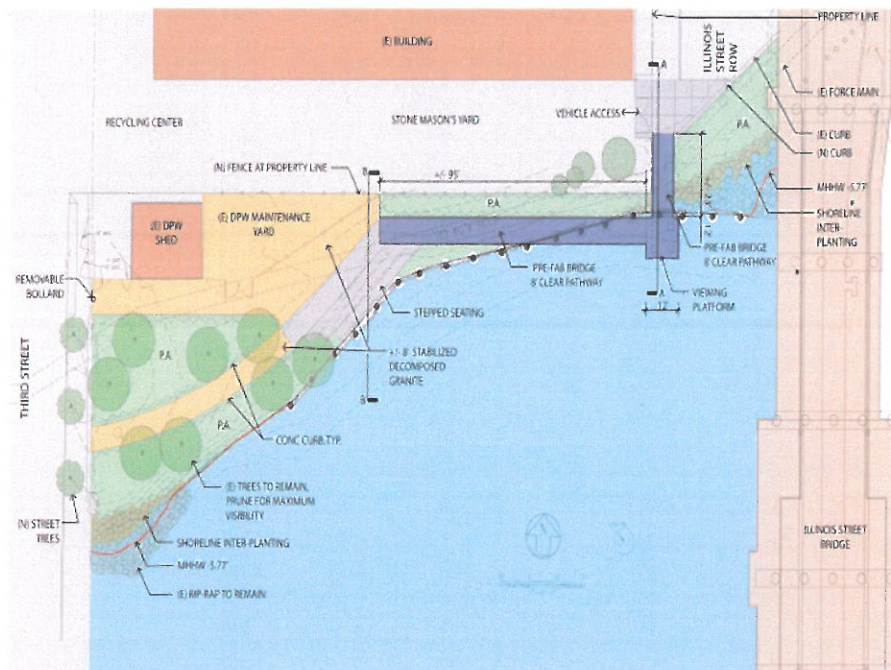

TULARE PARK CONCEPT PLAN  
Port of San Francisco

July, 2011  
SFPDW Landscape Architecture

Budget	GO Bond	Total Funds
Original Budget	\$585,000	\$860,000
Current Approved Budget	\$585,000	\$860,000
Actual Expenditures To Date	\$317,211	\$317,211

Schedule	Original	Current Forecast or Actual
Planning	April 2011	April 2011
Design	October 2012	October 2012
Construction	October 2012	April 2014
Completion	December 2013	January 2015

## Project Schedules

### **Blue Greenway Public Art**

**Project Location:** Blue Greenway Mission Creek and Heron's Park

**Project Manager:** David Beaupre, [david.beaupre@sfport.org](mailto:david.beaupre@sfport.org); (415) 274-0539

Working with the SF Arts Commission, the Port identified the Bayview Gateway site as the appropriate site and location for the Port's Art Enrichment Project.

The SF Arts Commission released a call for artist to submit qualifications for the project in the fall of 2014 and expects to select 3 artists to submit proposals. The final artist will be selected in the summer of 2014 with fabrication and installation to begin in late 2014.

Budget	GO Bond	Total Funds
Original Budget	\$684,000	\$684,000
Current Approved Budget	\$684,000	\$684,000
Actual Expenditures To Date	\$21,660	\$21,660

Schedule	Original	Current Forecast or Actual
Planning	April 2011	July 2011
Design	March 2012	February 2014
Construction	May 2013	October 2014
Completion	August 2013	June 2015



## Project Schedules

### Crane Cove Park

**Project Location:** Nineteenth and Illinois Street

**Project Manager:** David Beaupre, [david.beaupre@sfpport.org](mailto:david.beaupre@sfpport.org); (415) 274-0539

Crane Cove Park is an approximately 9 acre Blue Greenway waterfront park located in the Central Waterfront generally between 19<sup>th</sup> and Mariposa Streets east of Illinois Street. Initial park concepts include shoreline cleanup and stabilization, restoration of historic cranes, historic interpretation, bay access, and a facility for human powered boats. The total cost for the entire project is expected to be \$45 million dollars, which is greater than the current available funding. As a result, the project will be phased as funding is secured. Available funding for the 1<sup>st</sup> phase of the project is \$21,324,148 million, including (a) 10,024,148 in 2008 Clean and Safe Neighborhood Park G.O. Bonds, (b) \$8,000,000 from 2012 Clean and Safe Neighborhood Parks G.O. Bonds, and (c) \$3,300,000 in other Port funds.

This Blue Greenway Project benefits from significant planning conducted through the development of the Port's Pier 70 Preferred Master Plan and the Blue Greenway Planning and Design Guidelines community planning process.

A draft Park Master plan was reviewed with the Port Commission and Port's Waterfront Design Review Board in December of 2012 and January, June, September, and December of 2013. The Port has created a web site to allow the public to review work products and track the project status at [www.sfpport.com/cranecovepark](http://www.sfpport.com/cranecovepark).

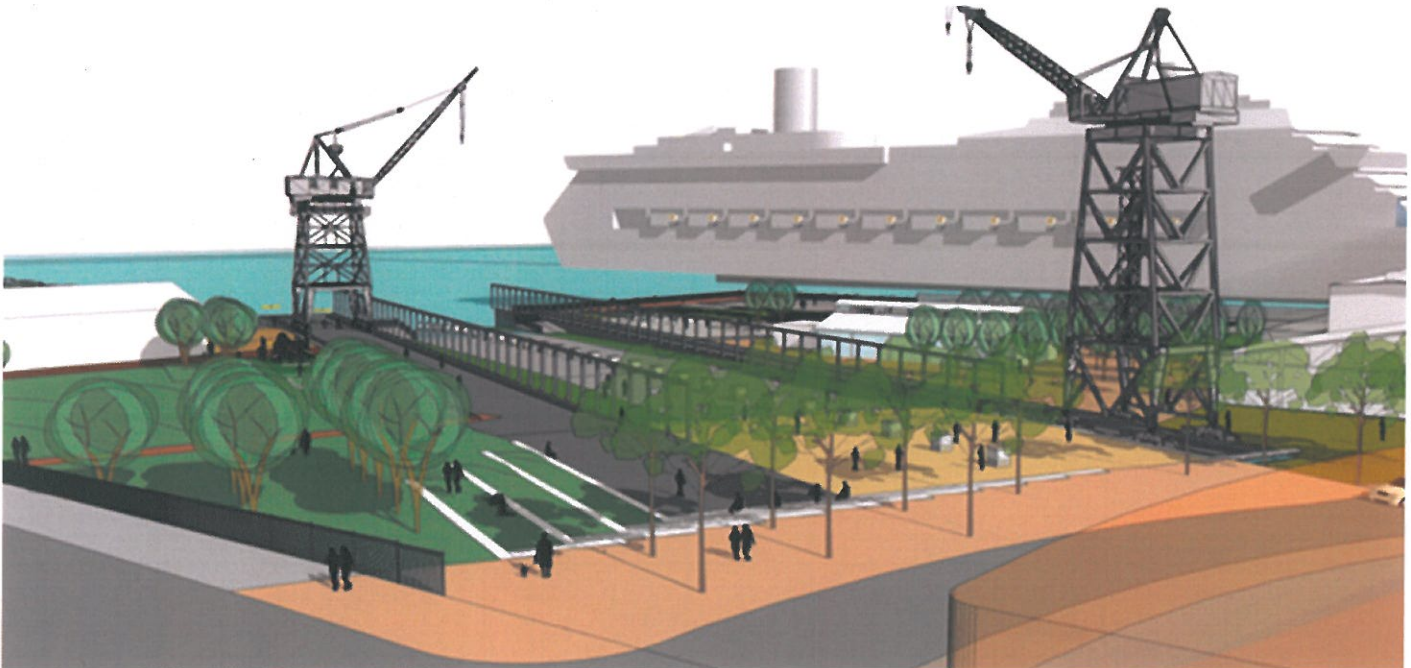

Budget	GO Bond	Total Funds
Original Budget	\$10,024,148	\$11,124,148
Current Approved Budget	\$10,024,148	\$21,324,148
Actual Expenditures To Date	\$488,088	\$488,088

Schedule	Original	Current Forecast or Actual
Planning	September 2011	September 2011
Design	March 2013	March 2014
Construction	February 2014	April 2015
Completion	February 2015	October 2016

## Project Schedules

### **Blue Greenway Signage and Site Furnishings**

**Project Location:** Blue Greenway Linking Streets between Mission Creek and Heron's Head Park

**Project Manager:** David Beaupre, [david.beaupre@sfpport.org](mailto:david.beaupre@sfpport.org); (415) 274-274-0539

The Blue Greenway is the City's project to improve the City's southerly portion of the 500 mile, 9-county, region-wide Bay Trail. Uniquely, the trail does not follow one continuous waterfront path or have consistent water views to serve as a navigational tool for users; users have to consciously find transitions and make decisions in order to stay on the system. Additionally, because the Blue Greenway is in its early inception, it lacks recognition by the general public. In order to help build identity and allow users to find their way along the system, the Port, working with our stakeholders, has developed a signage and way-finding program to build identity and provide users orientation to find their way along the system. The program includes large customized signs (as conceptualized in the diagram) which include navigational information.

The contract to construct and install these custom signs went out to bid in late March 2013 and a contract was awarded with Port Commission approval.

In addition to signage, furnishings such as benches and waste receptacles will be provided at the sign sites where practicable.

This Project went out to bid in late March 2013, the Port commission approved the award of the bid and the signage portion of the project will be substantially completed by April 2014, with the remaining minor site improvements completed in Sept 2014.



***This project budget is subject to change under a pending supplemental appropriation, currently before the Board of Supervisors. The approved budget shown below will be updated after the appropriate approvals have been granted.***

Budget	GO Bond	Total Funds
Original Budget	\$434,000	\$434,000
Current Approved Budget	\$1,458,000	\$1,458,000
Actual Expenditures To Date	\$180,996	\$180,996

Schedule	Original	Current Forecast or Actual
Planning	June 2011	April 2011
Design	January 2012	January 2012
Construction	January 2013	June 2013
Completion	August 2013	September 2014

## Project Schedules

### **Bayview Gateway**

**Project Location:** Islais Creek shoreline, south side between Illinois and Third Streets

**Project Managers:** David Beaupre, [david.beaupre@sfpport.org](mailto:david.beaupre@sfpport.org); (415) 274-0539 (Planning)  
Steven Reel, [steven.reel@sfpport.org](mailto:steven.reel@sfpport.org); (415) 274-0574 (Engineering)

The Bayview Gateway Project will create a new one acre public open space along the southern bank of Islais Creek in San Francisco's southeast waterfront. The project site is bound by Islais Creek on the north, Cargo Way on the south, 3rd Street on the west, and Illinois Street on the east. This area was reclaimed from the Bay in the 1900s and served as a working waterfront with a timber wharf and shed. The shed was removed in the early 1980s leaving an asphalt covered lot. The project will demolish the existing timber wharf, rehabilitate the seawall, and transform the asphalt lot into a public park with walkways, plaza spaces and green spaces from which to enjoy the Bay. In addition, the project will serve as both a gateway to and an amenity for the Bayview neighborhood.

Construction estimates early in the design phase indicated the project would cost 13% more than the current budget. Value engineering measures were taken to simplify the design with some success. However, additional project scope was added for unanticipated right of way improvements including a new crosswalk at 3rd Street, modifications and repairs to the adjacent sidewalks, and more extensive roadway and traffic signal work at 3rd Street and Cargo Way. The total project cost is now estimated at \$3.9 M, approximately 18% (\$0.5M) above the original budgeted amount of \$3.3 M.

***This project budget is subject to change under a pending supplemental appropriation, currently before the Board of Supervisors. The approved budget shown below will be updated after the appropriate approvals have been granted.***



Budget	GO Bond	Total Funds
Original Budget	\$3,282,125	\$3,282,125
Current Approved Budget	\$3,282,125	\$3,282,125
Actual Expenditures To Date	\$296,999	\$296,999

Schedule	Original	Current Forecast or Actual
Planning	September 2011	September 2011
Design	March 2012	March 2012
Construction	October 2012	April 2014
Completion	August 2013	January 2015

**2008 Clean & Safe Neighborhood Park G.O. Bond  
Program Budget Reports - Revenues as of 2/28/14**

PROGRAMS	CURRENT/ FORECAST BUDGET	2008 CSP BONDS	2000 NP BONDS	OPEN SPACE FUNDS	REVENUE BONDS	GENERAL FUND	GIFTS	GRANTS	BART FUNDS	OTHER PORT FUNDS	TOTAL SOURCES
<b>NEIGHBORHOOD PARKS</b>											
1 Cabrillo Playground Renovation	4,500,000	4,500,000	-	46,591	-	-	-	-	-	-	4,546,591
11 Cayuga Playground	8,699,256	7,300,000	-	-	-	-	-	710,779	1,399,256	-	9,410,035
3 Chinese Recreation Center	20,487,430	13,249,645	-	-	6,287,430	-	-	-	-	-	19,537,075
1 Fulton Playground	4,620,000	4,935,000	-	-	-	-	-	-	-	-	4,935,000
8 Glen Canyon Park Renovation	5,800,000	5,800,000	-	-	-	-	-	-	-	-	5,800,000
2 Lafayette Park Renovation	10,200,000	10,200,000	-	-	-	-	200,000	-	-	-	10,400,000
4 McCoppin Square Playground	5,300,000	3,800,000	-	-	-	-	-	-	-	-	3,800,000
8 Mission Dolores Park Renovation	11,700,000	16,500,000	-	-	97,175	-	-	-	-	-	16,597,175
8 Mission Dolores Park-Helen Diller Playground	2,991,441	1,630,000	61,441	-	225,000	250,000	1,481,444	-	-	-	3,647,885
8 Mission Playground	7,500,000	9,317,000	-	-	-	-	40,000	-	-	-	9,357,000
9 Palega Playground	21,200,000	18,200,000	-	-	-	-	-	-	-	-	18,200,000
5 Raymond Kimbell Playground Renovation	3,300,000	4,100,000	-	-	-	-	-	-	-	-	4,100,000
4 Sunset Playground	13,700,000	13,900,000	-	-	-	-	-	15,069	-	-	13,915,069
NP Program Reserve	4,145,000	5,778,650	-	-	-	-	-	-	-	-	5,778,650
<b>SUBTOTAL FOR NEIGHBORHOOD PARKS</b>	<b>124,143,127</b>	<b>119,210,294</b>	<b>61,441</b>	<b>46,591</b>	<b>6,609,605</b>	<b>250,000</b>	<b>1,721,444</b>	<b>725,848</b>	<b>1,399,256</b>	<b>-</b>	<b>130,024,480</b>
<b>SPECIAL CITY-WIDE PROGRAMS</b>											
Community Opportunity Fund	5,000,000	5,500,000	-	-	-	-	-	4,943,000	-	-	10,863,501
Forestry	4,100,000	4,000,000	-	-	-	-	-	100,000	-	-	4,100,000
Playfields	8,500,000	8,700,000	-	-	-	-	-	-	-	-	8,700,000
Restroom Repair	11,400,000	11,400,000	-	-	-	-	-	-	-	-	11,400,000
Trail	5,000,000	5,000,000	-	-	-	-	-	626,157	-	-	5,626,157
<b>SUBTOTAL FOR SPECIAL CITY-WIDE PROGRAMS</b>	<b>34,000,000</b>	<b>34,600,000</b>	<b>-</b>	<b>-</b>	<b>-</b>	<b>-</b>	<b>420,501</b>	<b>5,669,157</b>	<b>-</b>	<b>-</b>	<b>40,689,658</b>
<b>WATERFRONT PARKS</b>											
Bayfront Park	2,950,000	2,950,000	-	-	-	-	-	-	-	-	2,950,000
Bayview Gateway	3,282,125	3,282,125	-	-	-	-	-	-	-	-	3,282,125
Blue-Greenway Planning & Design Guidelines	336,000	336,000	-	-	-	-	-	-	-	-	336,000
Blue-Greenway Public Art	684,000	684,000	-	-	-	-	-	-	-	-	684,000
Blue-Greenway Signage & Site Furnishings	1,458,000	1,458,000	-	-	-	-	-	-	-	-	1,458,000
Brannan Street Wharf	26,246,271	2,941,050	-	-	-	-	-	4,833,270	-	18,471,951	26,246,271
CEQA Review & Permitting	577,500	577,500	-	-	-	-	-	-	-	-	577,500
Crane Cove Park	21,324,148	1,813,250	-	-	-	-	-	-	-	1,100,000	2,913,250
Heron's Head Park	2,403,949	2,351,000	-	-	-	-	-	-	-	52,949	2,403,949
Pier 43 Bay Trail Link	10,191,508	7,677,800	-	-	-	-	-	90,000	-	2,423,708	10,191,508
Tulare Park	860,000	585,000	-	-	-	-	-	275,000	-	-	860,000
<b>SUBTOTAL FOR WATERFRONT PARKS</b>	<b>70,313,501</b>	<b>24,655,725</b>	<b>-</b>	<b>-</b>	<b>-</b>	<b>-</b>	<b>-</b>	<b>5,198,270</b>	<b>-</b>	<b>22,048,608</b>	<b>51,902,603</b>
<b>PROGRAM-WIDE SERVICES</b>											
Controller's Audit	185,000	526,245	-	-	-	-	-	-	-	-	526,245
Bond Issuance Cost	2,958,275	584,964	-	-	-	-	-	-	-	-	584,964
<b>SUBTOTAL FOR PROGRAM-WIDE SERVICES</b>	<b>3,143,275</b>	<b>1,111,209</b>	<b>-</b>	<b>-</b>	<b>-</b>	<b>-</b>	<b>-</b>	<b>-</b>	<b>-</b>	<b>-</b>	<b>1,111,209</b>
<b>GRAND TOTAL</b>	<b>231,599,903</b>	<b>179,577,229</b>	<b>61,441</b>	<b>46,591</b>	<b>6,609,605</b>	<b>250,000</b>	<b>2,141,945</b>	<b>11,593,275</b>	<b>1,399,256</b>	<b>22,048,608</b>	<b>223,727,950</b>

# 2008 Clean & Safe Neighborhood Park G.O. Bond Program Budget Reports - Expenditures as of 2/28/14

Project		Phase		Category		FAMIS									
						Baseline Budget		Budget		Expended		Encumbered		Balance	
						All Sources	2008 CSP Bond	All Sources	2008 CSP Bond	All Sources	2008 CSP Bond	All Sources	2008 CSP Bond	All Sources	2008 CSP Bond
Neighborhood Parks Cabrillo Playground Renovation		CLOSED OUT		Soft Costs		1,017,428	1,017,428								
				Construction Costs		3,083,116	3,083,116								
				Project Contingency		399,456	399,456								
				<b>SUBTOTAL</b>		<b>4,500,000</b>	<b>4,500,000</b>	<b>4,545,591</b>	<b>4,500,000</b>	<b>4,475,922</b>	<b>4,443,185</b>	<b>9,309</b>	<b>9,309</b>		
Cayuga Playground Renovation		CLOSED OUT		Soft Costs		2,115,591	1,653,837								
				Construction Costs		6,410,882	5,011,626								
				Project Contingency		172,783	634,537								
				<b>SUBTOTAL</b>		<b>8,699,256</b>	<b>7,300,000</b>	<b>9,410,035</b>	<b>7,300,000</b>	<b>9,247,605</b>	<b>7,193,843</b>	<b>153,049</b>	<b>147,258</b>		
Chinese Recreation Center		CLOSED OUT		Soft Costs		3,849,238	12,900,620								
				Construction Costs		15,336,812	1,299,380								
				Project Contingency		1,299,380	14,200,000								
				<b>SUBTOTAL</b>		<b>20,487,430</b>	<b>14,200,000</b>	<b>19,537,075</b>	<b>13,249,645</b>	<b>19,363,651</b>	<b>13,115,628</b>	<b>11,043</b>	-		134,016
Fulton Playground Renovation		CLOSED OUT		Soft Costs		1,075,792	1,075,792								
				Construction Costs		3,259,975	3,259,975								
				Project Contingency		284,233	284,233								
				<b>SUBTOTAL</b>		<b>4,620,000</b>	<b>4,620,000</b>	<b>4,935,000</b>	<b>4,935,000</b>	<b>4,914,820</b>	<b>4,914,820</b>	<b>6,918</b>	<b>6,918</b>		13,263
Glen Canyon Park Renovation		CONSTRUCTION		Soft Costs		1,300,827	1,300,827								
				Construction Costs		3,941,899	3,941,899								
				Project Contingency		557,274	557,274								
				<b>SUBTOTAL</b>		<b>5,800,000</b>	<b>5,800,000</b>	<b>5,800,000</b>	<b>5,800,000</b>	<b>5,523,519</b>	<b>5,523,519</b>	<b>178,328</b>	<b>178,328</b>		98,153
Lafayette Park Renovation		CLOSED OUT		Soft Costs		2,314,257	2,314,257								
				Construction Costs		7,012,900	7,012,900								
				Project Contingency		872,843	872,843								
				<b>SUBTOTAL</b>		<b>10,200,000</b>	<b>10,200,000</b>	<b>10,400,000</b>	<b>10,200,000</b>	<b>10,073,439</b>	<b>9,889,688</b>	<b>22,868</b>	<b>6,619</b>		303,694
McCoppin Square Renovation		CLOSED OUT		Soft Costs		1,202,174	1,202,174								
				Construction Costs		3,642,953	3,642,953								
				Project Contingency		454,873	454,873								
				<b>SUBTOTAL</b>		<b>5,300,000</b>	<b>5,300,000</b>	<b>3,800,000</b>	<b>3,800,000</b>	<b>3,558,925</b>	<b>3,558,925</b>	-	-		241,075
Mission Dolores Park Renovation		CONSTRUCTION		Soft Costs		3,021,400	3,021,400								
				Construction Costs		7,857,200	7,857,200								
				Project Contingency		821,400	821,400								
				<b>SUBTOTAL</b>		<b>11,700,000</b>	<b>11,700,000</b>	<b>18,597,175</b>	<b>16,500,000</b>	<b>2,556,424</b>	<b>2,610,192</b>	<b>12,542,804</b>	<b>12,542,804</b>		1,348,003
Mission Dolores Park-Helen Diller Playground		CLOSED OUT		Soft Costs		461,441	-								
				Construction Costs		2,530,000	1,650,000								
				Project Contingency		-	-								
				<b>SUBTOTAL</b>		<b>2,991,441</b>	<b>1,650,000</b>	<b>3,647,885</b>	<b>1,630,000</b>	<b>3,550,167</b>	<b>1,589,930</b>	-	-		40,070
Mission Playground		CLOSED OUT		Soft Costs		1,710,595	1,710,595								
				Construction Costs		5,183,622	5,183,622								
				Project Contingency		605,783	605,783								
				<b>SUBTOTAL</b>		<b>7,500,000</b>	<b>7,500,000</b>	<b>9,357,000</b>	<b>9,317,000</b>	<b>9,034,203</b>	<b>8,998,613</b>	<b>274,740</b>	<b>270,349</b>		48,038
Palega Playground Renovation		CLOSED OUT		Soft Costs		4,826,692	4,826,692								
				Construction Costs		14,626,340	14,626,340								
				Project Contingency		1,746,968	1,746,968								
				<b>SUBTOTAL</b>		<b>21,200,000</b>	<b>21,200,000</b>	<b>18,200,000</b>	<b>18,200,000</b>	<b>16,651,886</b>	<b>16,651,886</b>	<b>98,727</b>	<b>98,727</b>		1,449,387
Raymond Kimbell Playground Renovation		BID/AWARD		Soft Costs		741,348	741,348								
				Construction Costs		2,246,508	2,246,508								
				Project Contingency		312,144	312,144								
				<b>SUBTOTAL</b>		<b>3,300,000</b>	<b>3,300,000</b>	<b>4,100,000</b>	<b>4,100,000</b>	<b>635,463</b>	<b>635,463</b>	<b>9,160</b>	<b>9,160</b>		3,455,377
Sunset Playground Renovation		CLOSED OUT		Soft Costs		3,124,135	3,124,135								
				Construction Costs		9,467,077	9,467,077								
				Project Contingency		1,108,788	1,108,788								
				<b>SUBTOTAL</b>		<b>13,700,000</b>	<b>13,700,000</b>	<b>13,915,069</b>	<b>13,900,000</b>	<b>13,708,998</b>	<b>13,693,929</b>	<b>5,844</b>	<b>5,844</b>		200,227
NP CAPITAL RESERVE				Program Contingency		4,145,000	4,145,000								
				Soft Costs		23,739,519	21,988,485								
				Construction Costs		76,744,084	79,883,836								
				Project Contingency		8,635,924	9,097,679								
NEIGHBORHOOD PARKS				<b>SUBTOTAL</b>		<b>124,145,127</b>	<b>115,115,000</b>	<b>130,024,480</b>	<b>119,210,294</b>	<b>103,395,020</b>	<b>92,819,620</b>	<b>13,312,790</b>	<b>13,275,316</b>		13,116,358

**2008 Clean & Safe Neighborhood Park G.O. Bond  
Program Budget Reports - Expenditures as of 2/28/14**

Project	Phase	Category	Baseline Budget						FAMIS					
			2008 CSP Bond			Budget			Expended			Encumbered		
			All Sources	2008 CSP Bond	All Sources	2008 CSP Bond	All Sources	2008 CSP Bond	All Sources	2008 CSP Bond	All Sources	2008 CSP Bond	2008 CSP Bond	Balance
Community Opportunity Fund	PLAN/DES/CONST	Forestry	5,000,000	5,000,000	10,863,501	5,500,000	5,957,138	2,990,106	5,957,138	2,990,106	2,500,032	471,617	2,038,277	
	PLAN/DES/CONST	Playfields	4,100,000	4,000,000	4,100,000	4,000,000	2,528,373	2,428,373	2,528,373	2,428,373	144,141	144,141	1,427,487	
	PLAN/DES/CONST	Restroom Repair	8,500,000	8,500,000	8,700,000	8,700,000	1,004,710	1,004,710	1,004,710	1,004,710	2,927,717	2,927,717	4,767,573	
	PLAN/DES/CONST	Trail	11,400,000	11,400,000	11,400,000	11,400,000	8,975,740	8,975,740	8,975,740	8,975,740	1,106,365	1,106,365	1,317,896	
	PLAN/DES/CONST		5,000,000	5,000,000	5,626,157	5,000,000	1,939,806	1,758,066	1,939,806	1,758,066	925,144	776,057	2,465,877	
<b>CITY-WIDE PROGRAMS SUB-TOTAL:</b>			<b>34,000,000</b>	<b>33,900,000</b>	<b>40,689,558</b>	<b>34,600,000</b>	<b>20,405,766</b>	<b>17,156,995</b>	<b>20,405,766</b>	<b>17,156,995</b>	<b>7,603,398</b>	<b>5,425,896</b>	<b>12,017,109</b>	
Bayfront Park	Soft Costs		443,150	443,150										
	Construction Costs		1,887,217	1,887,217										
	Project Contingency		619,633	619,633										
	<b>SUBTOTAL</b>		<b>2,950,000</b>	<b>2,950,000</b>	<b>2,950,000</b>	<b>2,950,000</b>	<b>2,330,367</b>	<b>2,330,367</b>	<b>2,330,367</b>	<b>2,330,367</b>	-	-	<b>619,633</b>	
	Soft Costs		463,379	463,379										
Bayview Gateway	Construction Costs		2,818,746	2,818,746										
	Project Contingency													
	<b>SUBTOTAL</b>		<b>3,282,125</b>	<b>3,282,125</b>	<b>3,282,125</b>	<b>3,282,125</b>	<b>296,999</b>	<b>296,999</b>	<b>296,999</b>	<b>296,999</b>	<b>9,427</b>	<b>9,427</b>	<b>2,975,699</b>	
	Soft Costs		336,000	336,000										
	Construction Costs													
Blue Greenway Planning & Design Guidelines	Project Contingency													
	<b>SUBTOTAL</b>		<b>336,000</b>	<b>336,000</b>	<b>336,000</b>	<b>336,000</b>	<b>325,472</b>	<b>325,472</b>	<b>325,472</b>	<b>325,472</b>	-	-	<b>10,528</b>	
	Soft Costs		100,000	100,000										
	Construction Costs		584,000	584,000										
	Project Contingency													
Blue-Greenway Public Art	<b>SUBTOTAL</b>		<b>684,000</b>	<b>684,000</b>	<b>684,000</b>	<b>684,000</b>	<b>21,660</b>	<b>21,660</b>	<b>21,660</b>	<b>21,660</b>	<b>149,340</b>	<b>149,340</b>	<b>513,000</b>	
	Soft Costs		175,000	175,000										
	Construction Costs		1,283,000	1,283,000										
	Project Contingency													
	<b>SUBTOTAL</b>		<b>1,458,000</b>	<b>1,458,000</b>	<b>1,458,000</b>	<b>1,458,000</b>	<b>180,996</b>	<b>180,996</b>	<b>180,996</b>	<b>180,996</b>	<b>767,916</b>	<b>767,916</b>	<b>509,088</b>	
Brannan Street Wharf Park	Soft Costs		3,299,268	3,299,268										
	Construction Costs		19,587,860	19,587,860										
	Project Contingency		3,359,153	3,359,153										
	<b>SUBTOTAL</b>		<b>26,246,271</b>	<b>26,246,271</b>	<b>26,246,271</b>	<b>26,246,271</b>	<b>24,739,505</b>	<b>24,739,505</b>	<b>24,739,505</b>	<b>24,739,505</b>	<b>35,294</b>	<b>35,294</b>	<b>-</b>	
	Soft Costs		577,500	577,500										
CEQA Review & Permitting	Construction Costs													
	Project Contingency													
	<b>SUBTOTAL</b>		<b>577,500</b>	<b>577,500</b>	<b>577,500</b>	<b>577,500</b>	<b>442,728</b>	<b>442,728</b>	<b>442,728</b>	<b>442,728</b>	<b>-</b>	<b>-</b>	<b>134,772</b>	
	Soft Costs		2,913,250	2,913,250										
	Construction Costs		18,410,898	18,410,898										
Crane Cove Park	Project Contingency													
	<b>SUBTOTAL</b>		<b>21,324,148</b>	<b>21,324,148</b>	<b>21,324,148</b>	<b>21,324,148</b>	<b>488,088</b>	<b>488,088</b>	<b>488,088</b>	<b>488,088</b>	<b>305,543</b>	<b>305,543</b>	<b>1,019,619</b>	
	Soft Costs		151,000	151,000										
	Construction Costs		2,252,949	2,252,949										
	Project Contingency													
Heron's Head Park	<b>SUBTOTAL</b>		<b>2,403,949</b>	<b>2,403,949</b>	<b>2,403,949</b>	<b>2,403,949</b>	<b>2,403,949</b>	<b>2,351,000</b>	<b>2,403,949</b>	<b>2,351,000</b>	<b>-</b>	<b>-</b>	<b>-</b>	
	Soft Costs		2,200,000	2,200,000										
	Construction Costs		7,991,508	7,991,508										
	Project Contingency													
	<b>SUBTOTAL</b>		<b>10,191,508</b>	<b>10,191,508</b>	<b>10,191,508</b>	<b>10,191,508</b>	<b>9,917,323</b>	<b>9,917,323</b>	<b>9,917,323</b>	<b>9,917,323</b>	<b>-</b>	<b>-</b>	<b>94,747</b>	
Pier 43 Bay Trail Link	Soft Costs		216,185	216,185										
	Construction Costs		643,815	643,815										
	Project Contingency													
	<b>SUBTOTAL</b>		<b>860,000</b>	<b>860,000</b>	<b>860,000</b>	<b>860,000</b>	<b>317,211</b>	<b>317,211</b>	<b>317,211</b>	<b>317,211</b>	<b>-</b>	<b>-</b>	<b>267,789</b>	
	Soft Costs		10,874,732	10,874,732										
Tulare Park	Construction Costs		55,459,983	55,459,983										
	Project Contingency		3,978,786	3,978,786										
	<b>SUBTOTAL</b>		<b>70,313,501</b>	<b>70,313,501</b>	<b>70,313,501</b>	<b>70,313,501</b>	<b>41,464,298</b>	<b>41,464,298</b>	<b>41,464,298</b>	<b>41,464,298</b>	<b>1,287,520</b>	<b>1,232,226</b>	<b>6,144,875</b>	
	Soft Costs													
	Construction Costs													
WATERFRONT PARKS	Project Contingency													
	<b>SUBTOTAL</b>		<b>185,000</b>	<b>185,000</b>	<b>185,000</b>	<b>185,000</b>	<b>568,245</b>	<b>568,245</b>	<b>568,245</b>	<b>568,245</b>	<b>1,649,866</b>	<b>130,266</b>	<b>0</b>	
	Soft Costs		2,958,275	2,958,275										
	Construction Costs													
	Project Contingency													
COGOC Audit Costs	<b>SUBTOTAL</b>		<b>231,599,903</b>	<b>231,599,903</b>	<b>231,599,903</b>	<b>231,599,903</b>	<b>166,401,574</b>	<b>166,401,574</b>	<b>166,401,574</b>	<b>166,401,574</b>	<b>25,483,441</b>	<b>20,063,704</b>	<b>31,280,273</b>	
	Bond Issuance Costs													
	<b>TOTAL PROGRAM:</b>													

## Timeline and Schedule

[illegible]

[illegible]